

PROVIDENCE, R.I.
CITY ENGINEER'S OFFICE
STREET LINE DEPT.
June 11, 1928.

050645

PLAT OF ERASTUS STREET

FROM ATWELLS AVE. TO FAIRMOUNT AVE.

SCALE 40 FEET PER INCH

*Declared and established as a Public Highway
by resolution of the Board of Aldermen
July 5, 1928.*

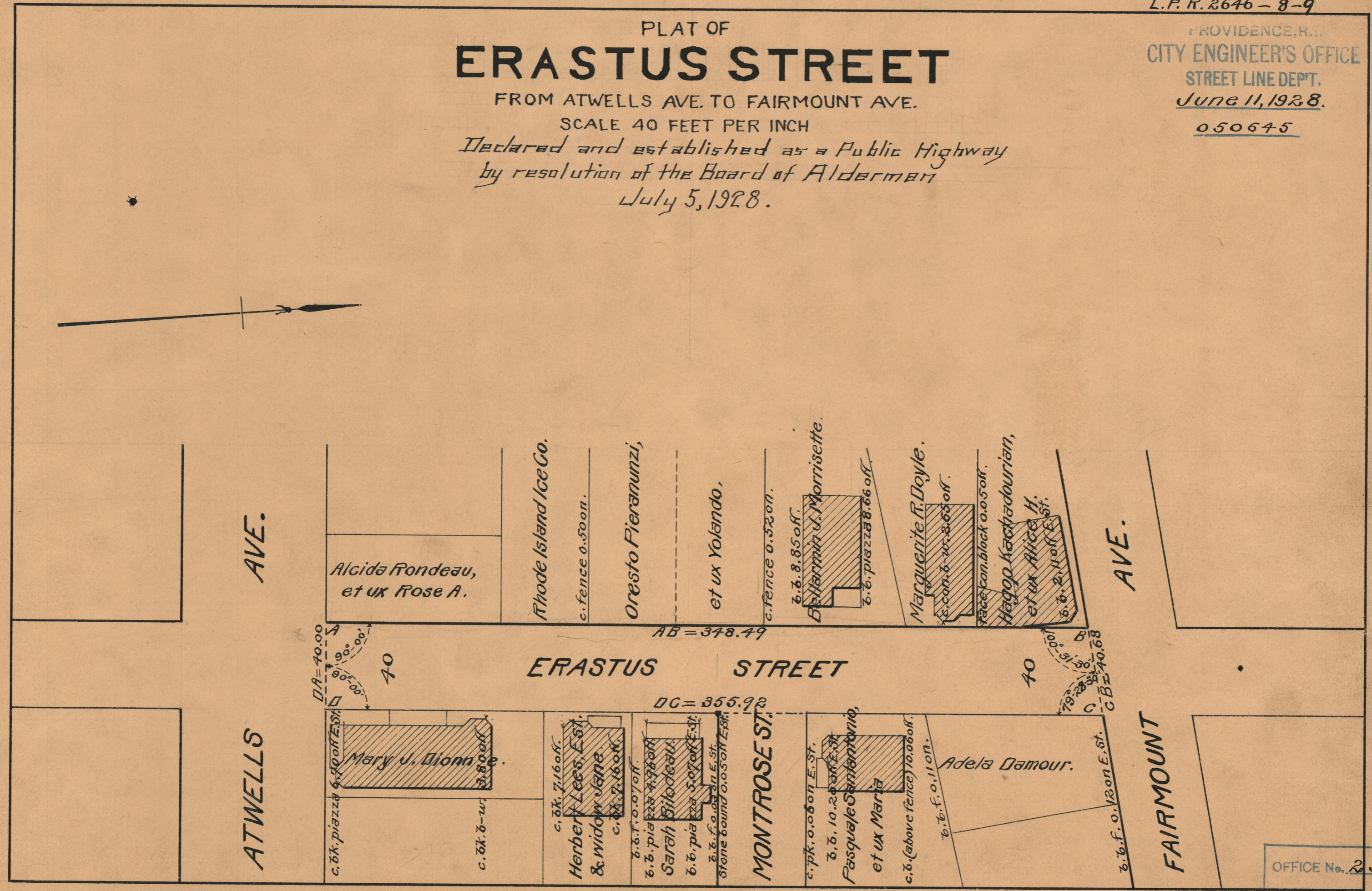
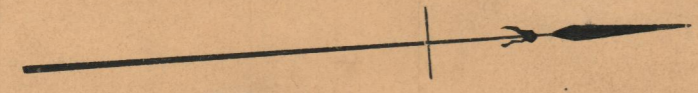

ATWELLS
AVE.

FAIRMOUNT
AVE.

ERASTUS STREET

MONTROSE ST.

OFFICE No. 23808
DRAWER " 73
SHEET " B-63