

PLAT OF
GRAND BROADWAY
 FROM VANDEWATER ST. TO NORTH LINE OF STANSBURY ST.
 SCALE 40 FEET PER INCH
 DECLARED A PUBLIC HIGHWAY BY RESOLUTION
 OF THE BOARD OF ALDERMEN
 OCTOBER 6, 1927

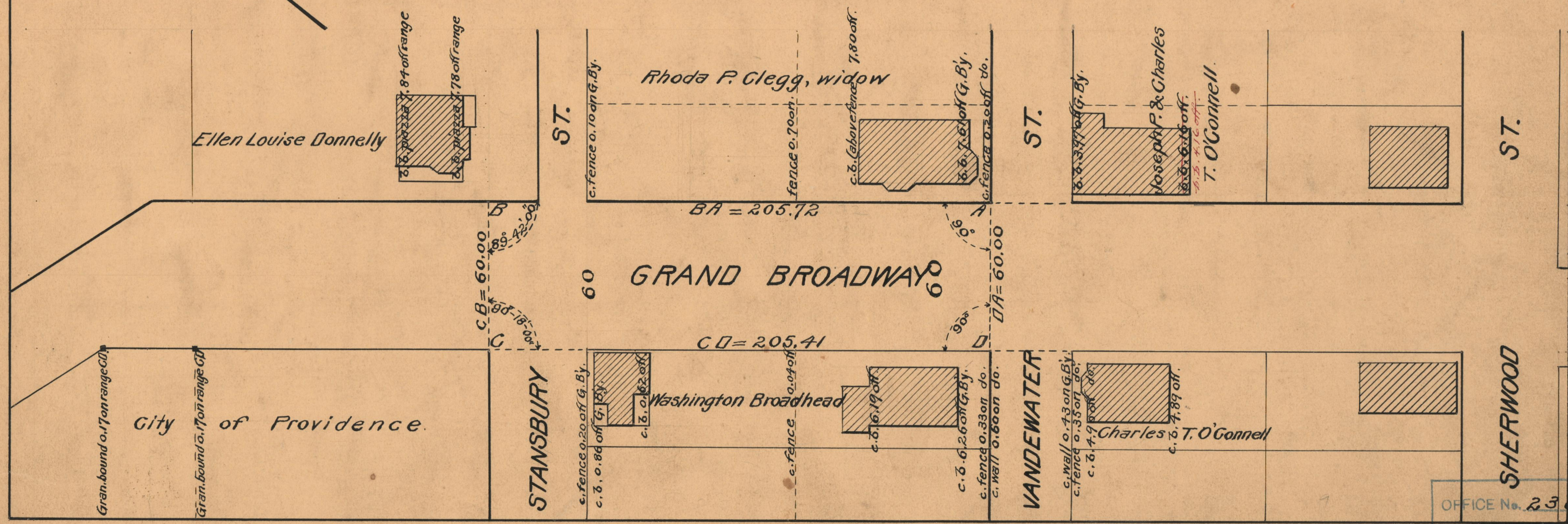
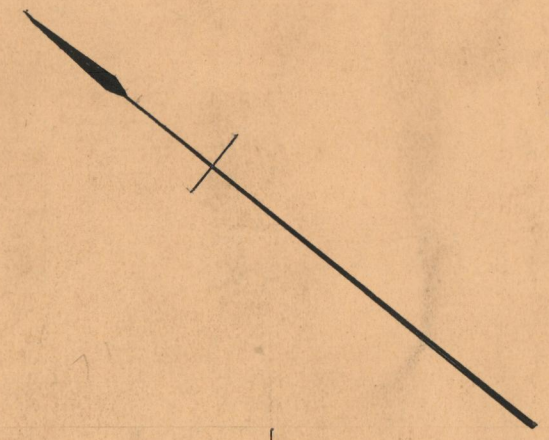

OFFICE No. 23657
 DRAWER " 73
 SHEET " B-20