

PROVIDENCE, R.I.
CITY ENGINEER'S OFFICE

STREET LINE DEPT.
July 28, 1927.

049767

PLAT OF COLONIAL ROAD

FROM SUMMIT AVE. TO NORTH MAIN ST.

IN TWO SHEETS

SCALE 60 FEET PER INCH

DECLARED A PUBLIC HIGHWAY BY RESOLUTION

OF THE BOARD OF ALDERMEN

APRIL 7, 1927

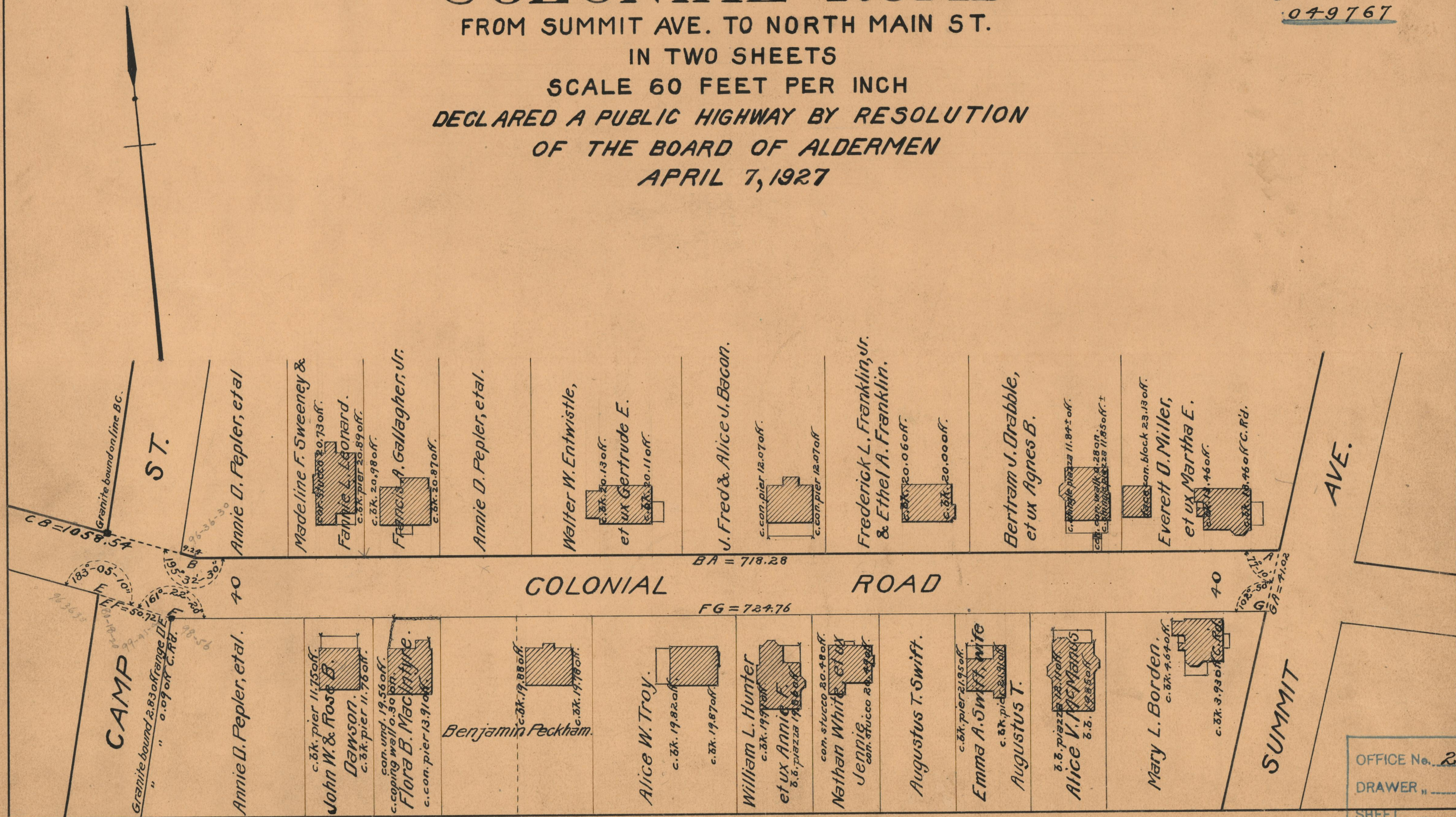

OFFICE No.	23570
DRAWER	73
SHEET	B-3