

# PLAT OF BUENA VISTA AVENUE

FROM SOUTH LINE OF HOMEFIELD AVE. TO SMITH ST.

SCALE 50 FEET PER INCH

DECLARED AND ESTABLISHED A PUBLIC HIGHWAY  
BY RESOLUTION OF THE BOARD OF ALDERMEN  
MAY 19, 1927

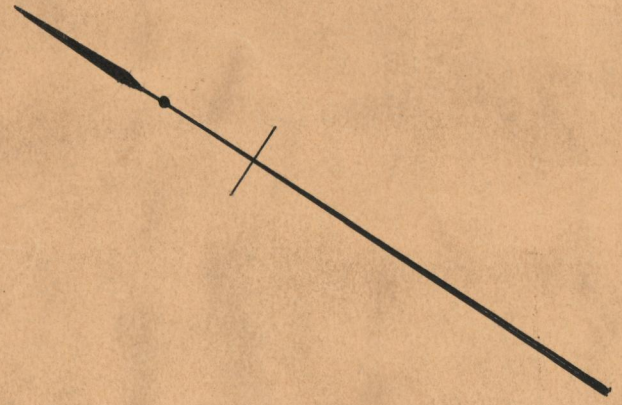

North Providence.  
Providence.

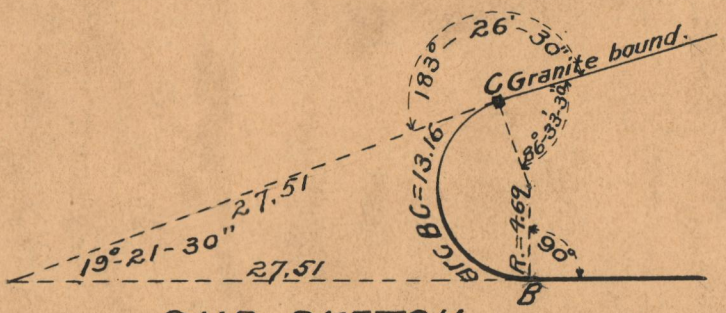

SUB SKETCH  
Scale 10 Feet per Inch.

STREET

Jane Olney,



c. und. 12.47 off.



c. 8.8. 8.61 off.

widow George.



Granite bound at angle.

BA = 192.92

79.11

SMITH

BUENA VISTA AVENUE

DE = 382.97

Town of  
City

John B. McGarry.

Granite bound at point D

ELMCREST AVE.

c. 3/4 post 0.26 on B. Ave.

Granite bound 0.09 on B. Ave.

Thomas E. Doherty,

et ux Martha E.



c. 3.38 off.

c. 2.28 off.

Esther G. Gushman.

HOMEFIELD AVE.

OFFICE No.	23521
DRAWER	73
SHEET	A-89