

PLAT OF MEETING STREET

FROM PROSPECT ST TO A POINT ABOUT 15 FEET EAST OF THAYER ST.

IN TWO SHEETS

SCALE 50 FEET PER INCH

DECLARED A PUBLIC HIGHWAY BY RESOLUTION OF THE BOARD OF ALDERMEN FEBRUARY 17, 1927

PROVIDENCE, R.I.
CITY ENGINEER'S OFFICE
STREET LINE DEPT.

March 16, 1929

051484

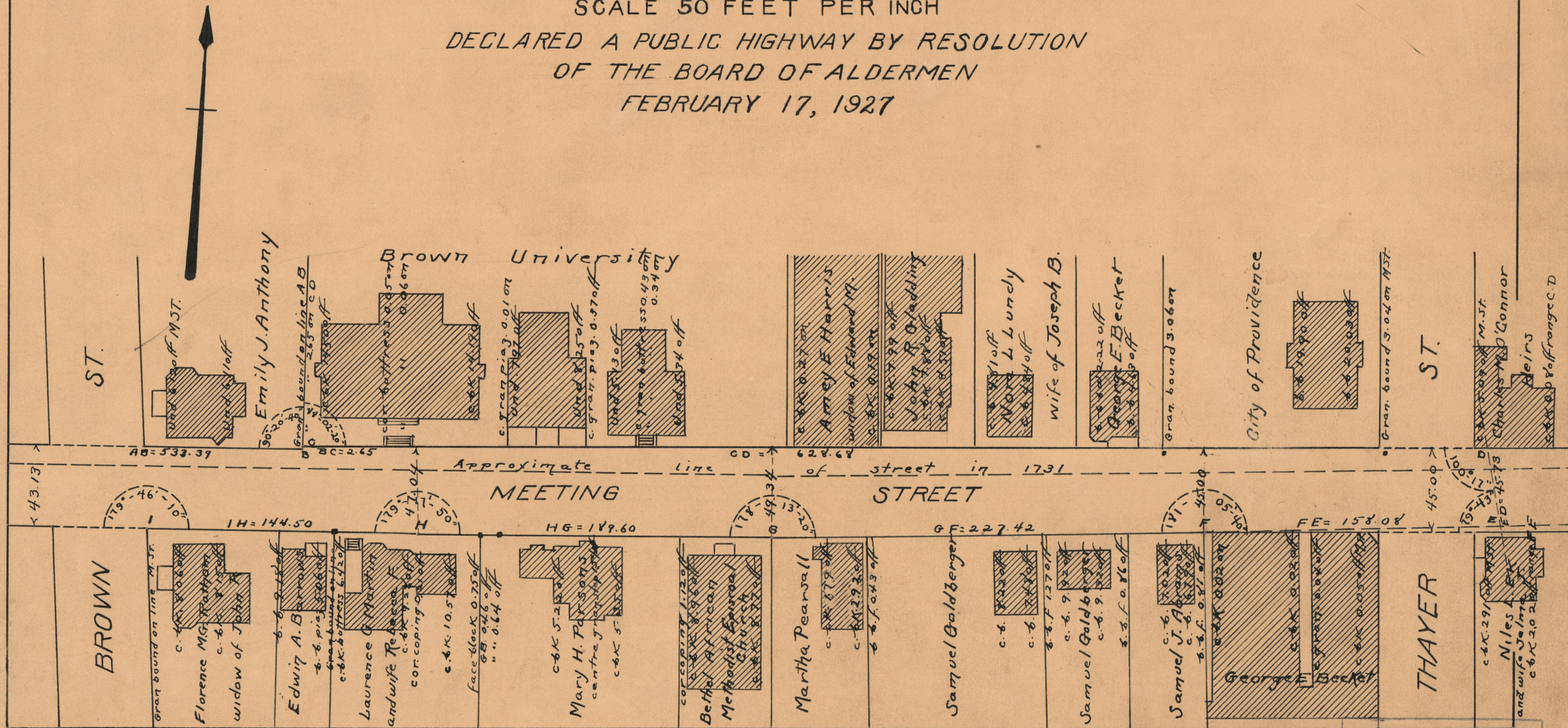

OFFICE No. 23462
 DRAWER " 73
 SHEET " A-80