

PROVIDENCE, R.I.
CITY ENGINEER'S OFFICE
STREET LINE DEPT.

Jan. 5, 1927

049239

PLAT OF ARMORY STREET

FROM NORTH MAIN ST. TO CAMP ST.
SCALE 50 FEET PER INCH

*Declared a public highway by Resolution of the
Board of Aldermen
October 21, 1926*

*Name changed to EDGEHILL ROAD
September 4, 1930.*

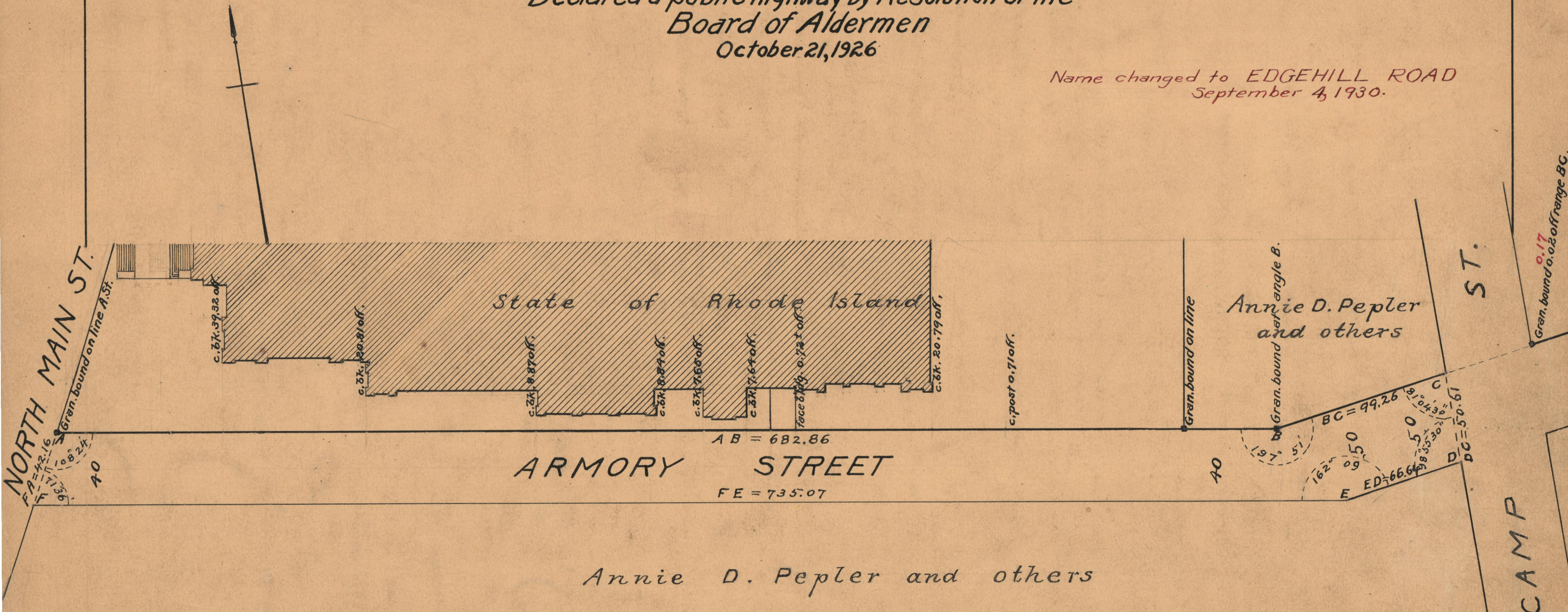

NORTH MAIN ST.
Gran. bound on line A St.
FA=42.16
FB=171.39
FC=24
40

Gran. bound 0.17 off range BC.

OFFICE No.	23407
DRAWER	73
SHEET	A-73