

T.F.C. 2213-107-9

PROVIDENCE, R.I.
CITY ENGINEER'S OFFICE
STREET LINE DEPT.

Jan. 5. 1927

049238

PLAT OF STENTON AVENUE

FROM NORTH MAIN ST. TO CAMP ST.
SCALE 50 FEET PER INCH

*Declared a public highway by Resolution of the
Board of Aldermen
October 21, 1926*

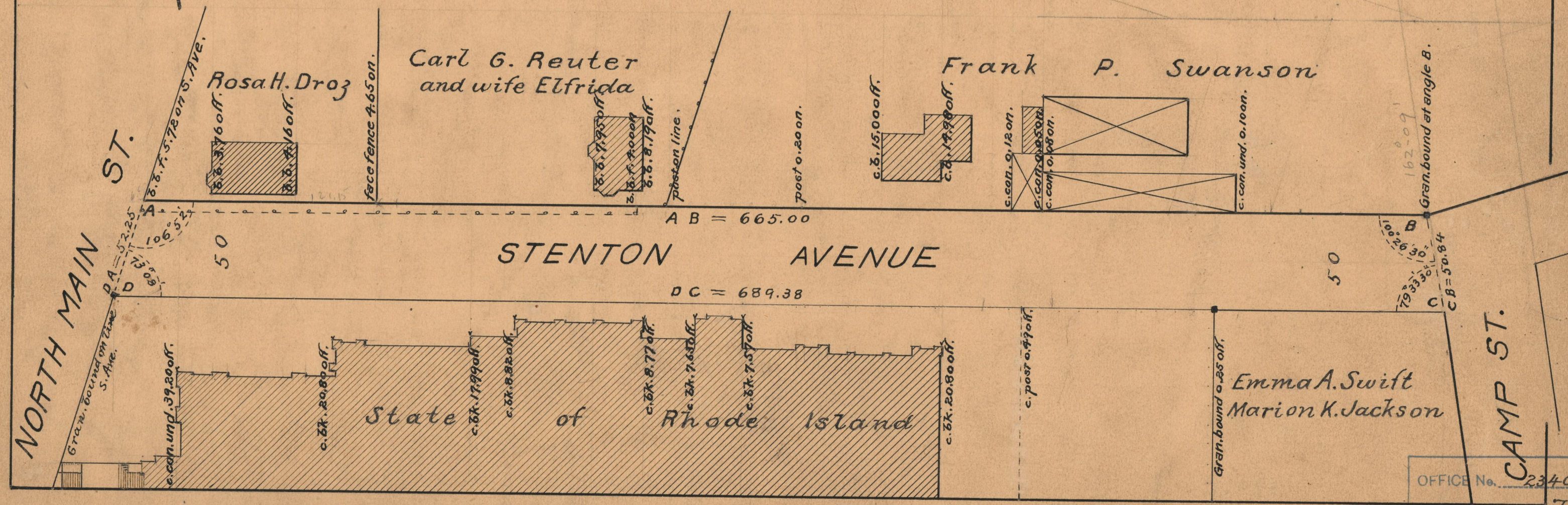

OFFICE No.	23406
DRAWER	73
SHEET	A-72