

Feb. 27, 1929

051438

PLAT OF

RUTHVEN STREET

FROM COLE AVE. TO SLATER AVE.
SCALE 40 FEET PER INCH

*Declared a public highway by Resolution of the
Board of Aldermen
July 1, 1926*

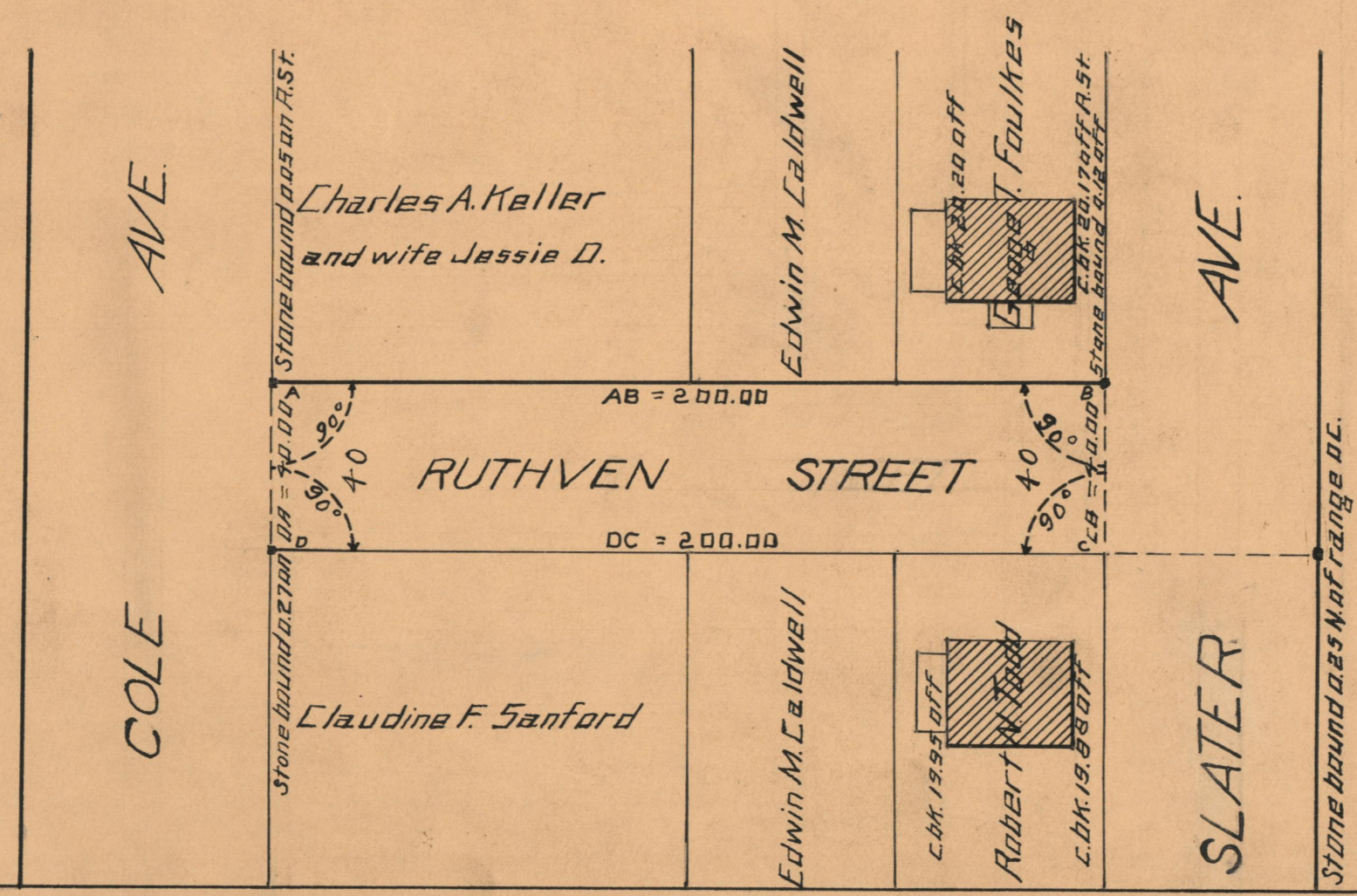
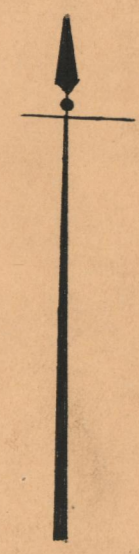

OFFICE No.	23314
DRAWER #	73
SHEET #	A-54