

PROVIDENCE, R.I.
CITY ENGINEER'S OFFICE
STREET LINE DEPT.

May 15, 1929

051797

PLAT OF
MODENA AVENUE
FROM SMITH ST. TO NORTHERLY LINE OF FORBES ST.
IN TWO SHEETS
SCALE 50 FEET PER INCH

DECLARED A PUBLIC HIGHWAY BY RESOLUTION
OF THE BOARD OF ALDERMEN
SEPTEMBER 17, 1925

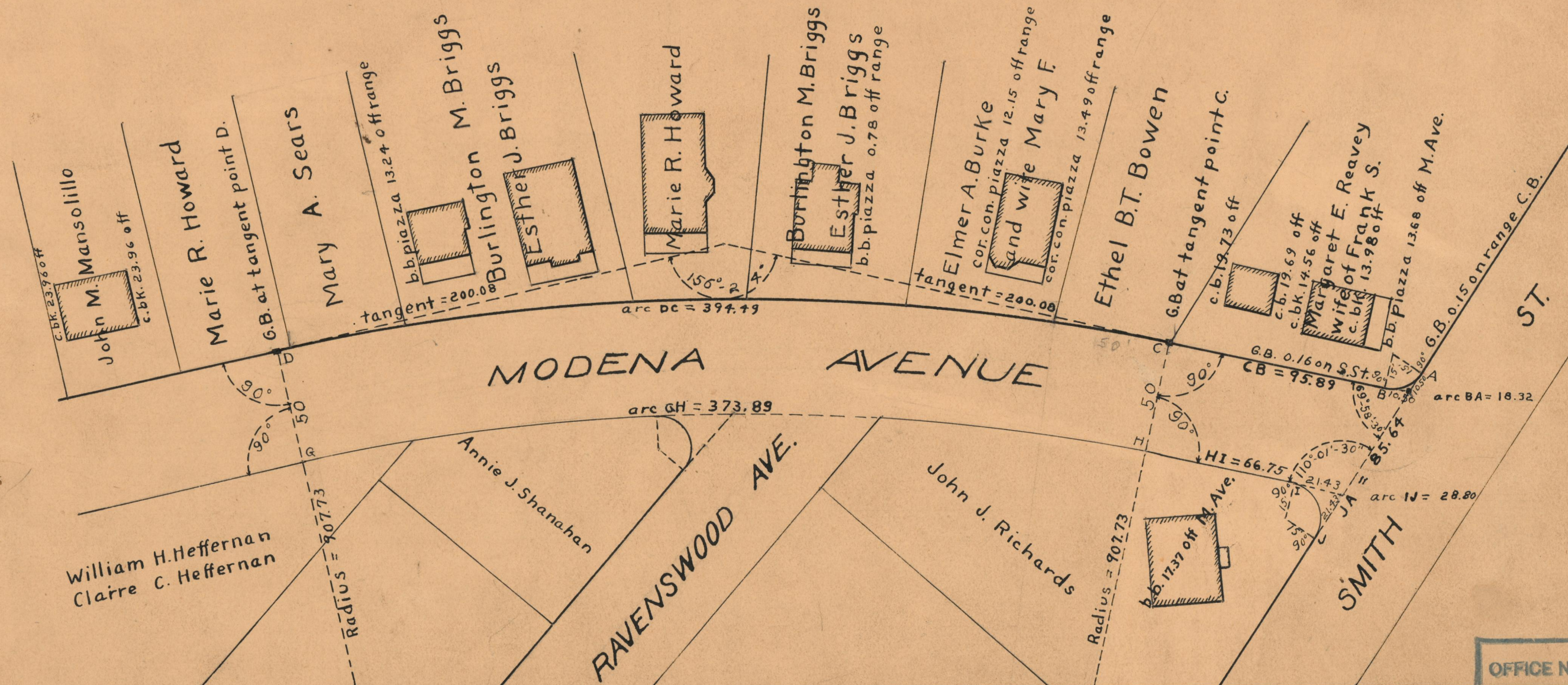
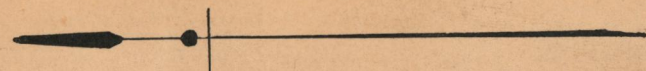

OFFICE No.	24138
DRAWER	73
SHEET	A-28