

PLAT
OF AN ESTATE BELONGING TO
ELIZA ANGELL
IN NORTH PROVIDENCE R.I.
by
CUSHING & FARNUM
1856

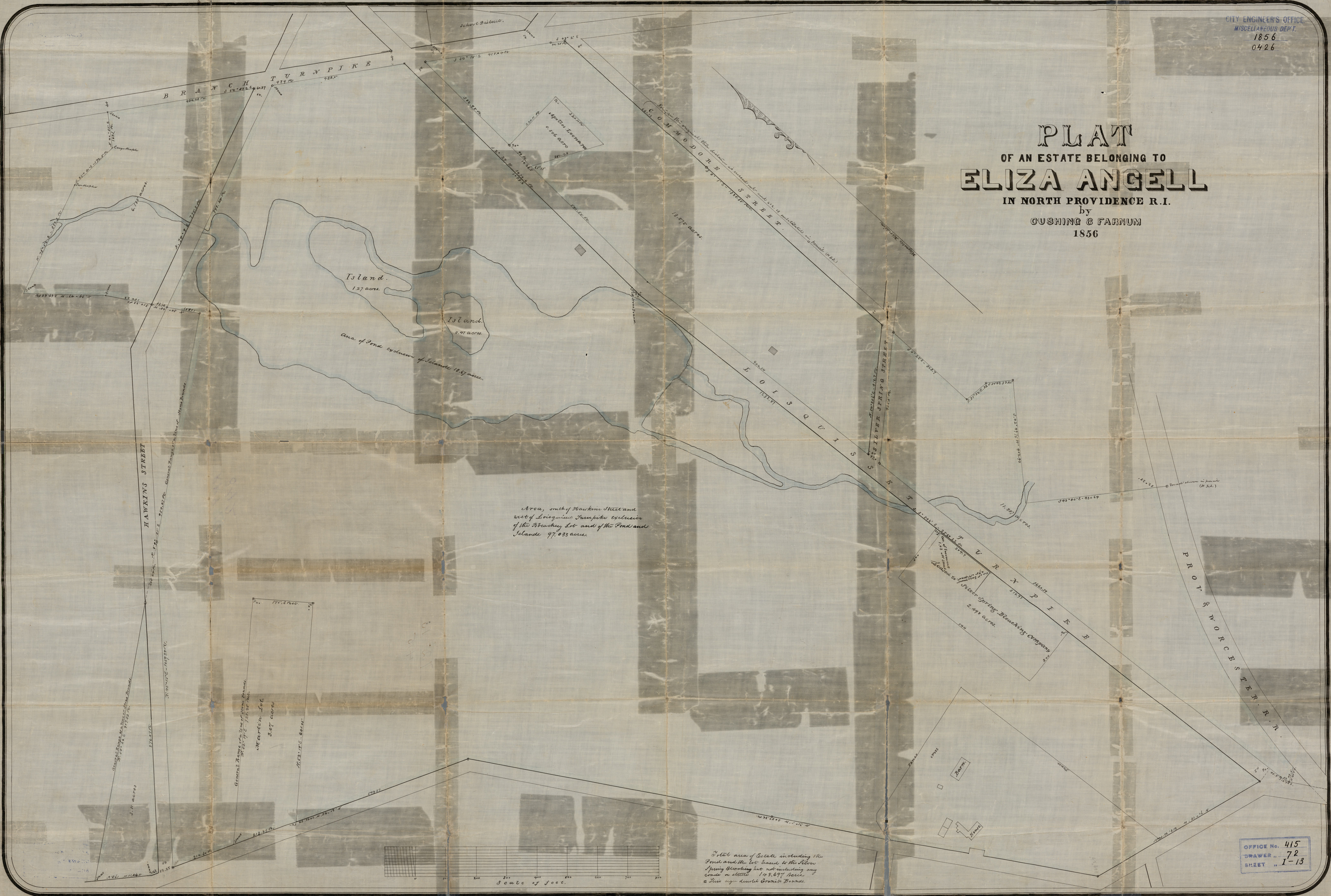

Area, south of Hawkins Street and
west of Loiquins Turnpike exclusive
of the Branch Lot and of the Pond and
Islands 97.033 acres.

Branch Lot
3.07 acres

Lot
2.497 acres

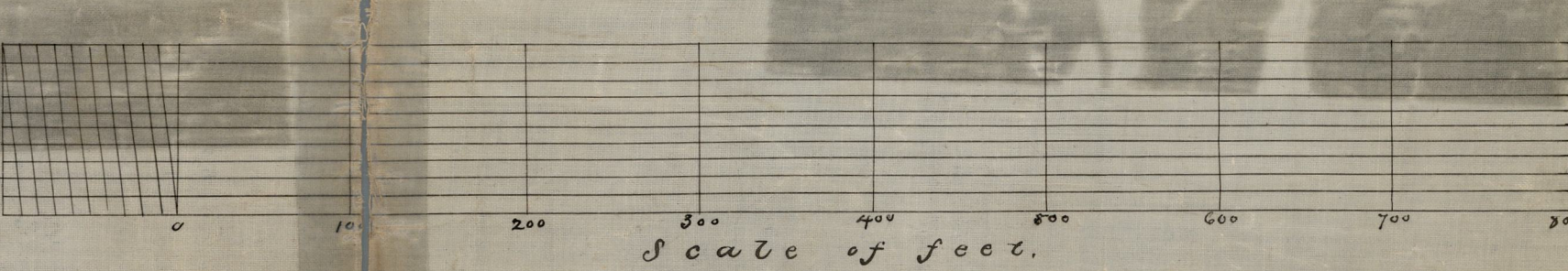

Total area of Estate including the
Pond and the lot owned to the
Spring Bleaching Co. not including any
lots or streets 148.697 acres.
a full up double Granite Board.

OFFICE No. 415
DRAWER 72
SHEET 1-13