

PROVIDED BY THE CITY ENGINEER'S OFFICE
MISCELLANEOUS D.P. 7
Aug. 21. 1922
045881

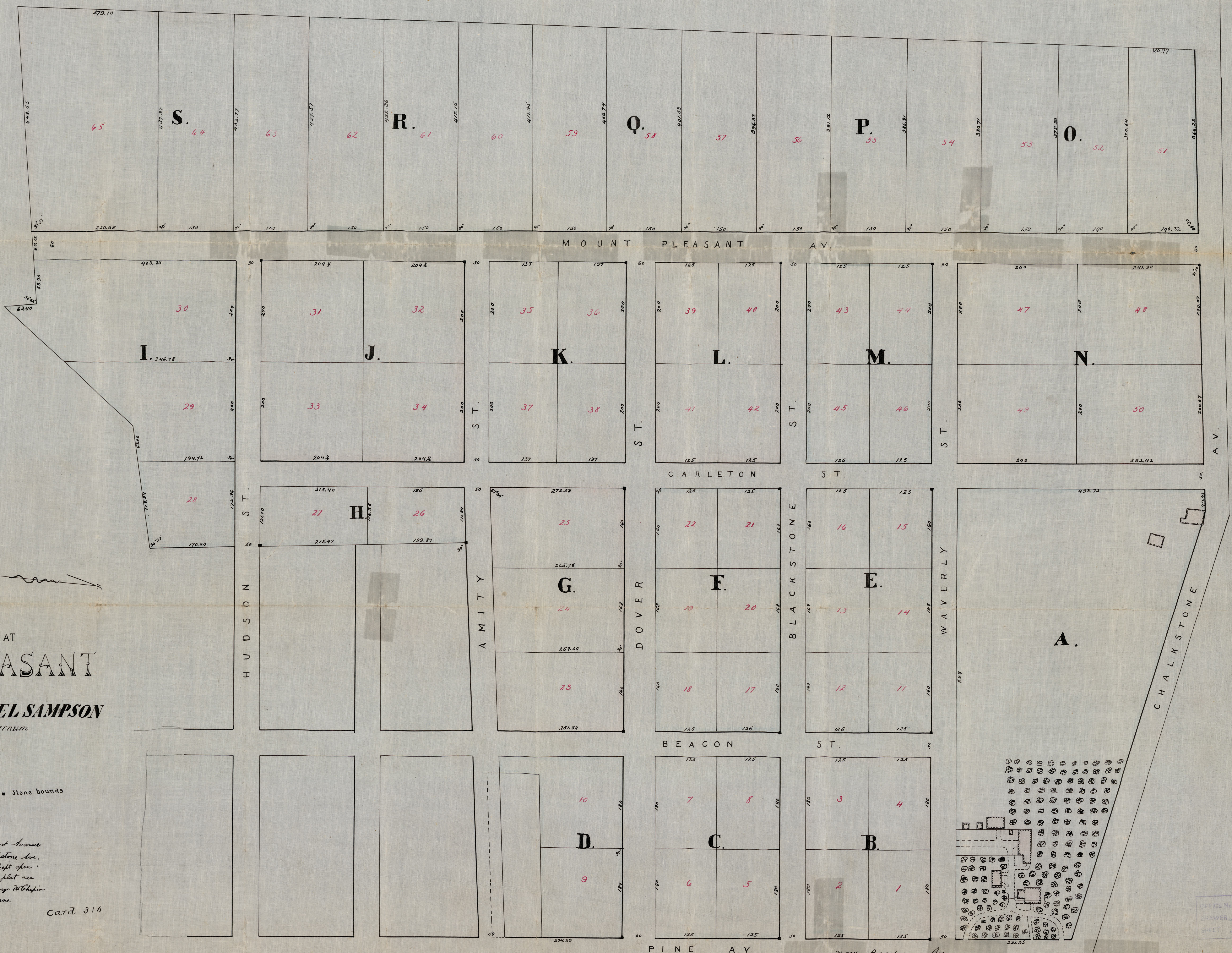

MAP OF VILLA LOTS AT MOUNT PLEASANT belonging to GEO. W. CHAPIN & ABIEL SAMPSON by Cushing & Farnum 1856.

Scale 80 ft. to an inch. Stone bounds

Note - Dover St and Mount Pleasant Avenue from the head of Swan St to Chalkstone Ave. are already opened and are to be kept open; but no other streets laid out by this plat are to be opened except at the option of George W. Chapin and Abiel Sampson their heirs or assigns.

Card 316