

Sarah Randall.

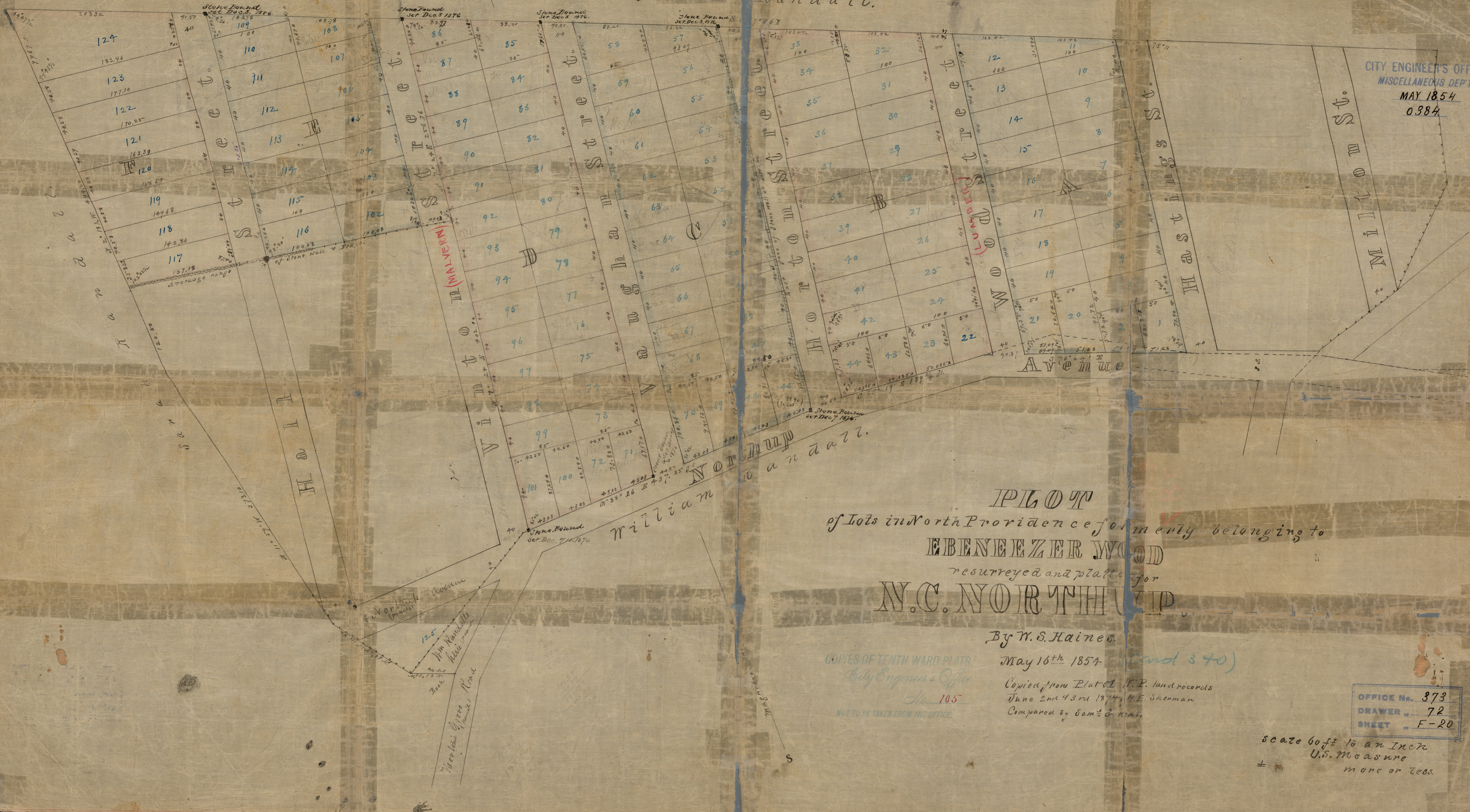

CITY ENGINEER'S OFFICE.
 MISCELLANEOUS DEPT.
 MAY 1854
 0384

PLAT
 of Lots in North Providence formerly belonging to
 EBENEZER WOOD
 resurveyed and platted for
 W.C. NORTHROP.

By W.S. Haines.

COPIES OF TENTH WARD PLATS
 City Engineer's Office
 No. 105
 NOT TO BE TAKEN FROM THIS OFFICE.

May 16th 1854 (and 340)
 Copied from Plat 51 N.P. land records
 June 2nd & 3rd 1874, H.E. Sherman
 Compared by Saml. B. Kent.

OFFICE No. 373
 DRAWER 72
 SHEET F-20

Scale 60ft to an Inch
 U.S. Measure
 ± more or less.