

North

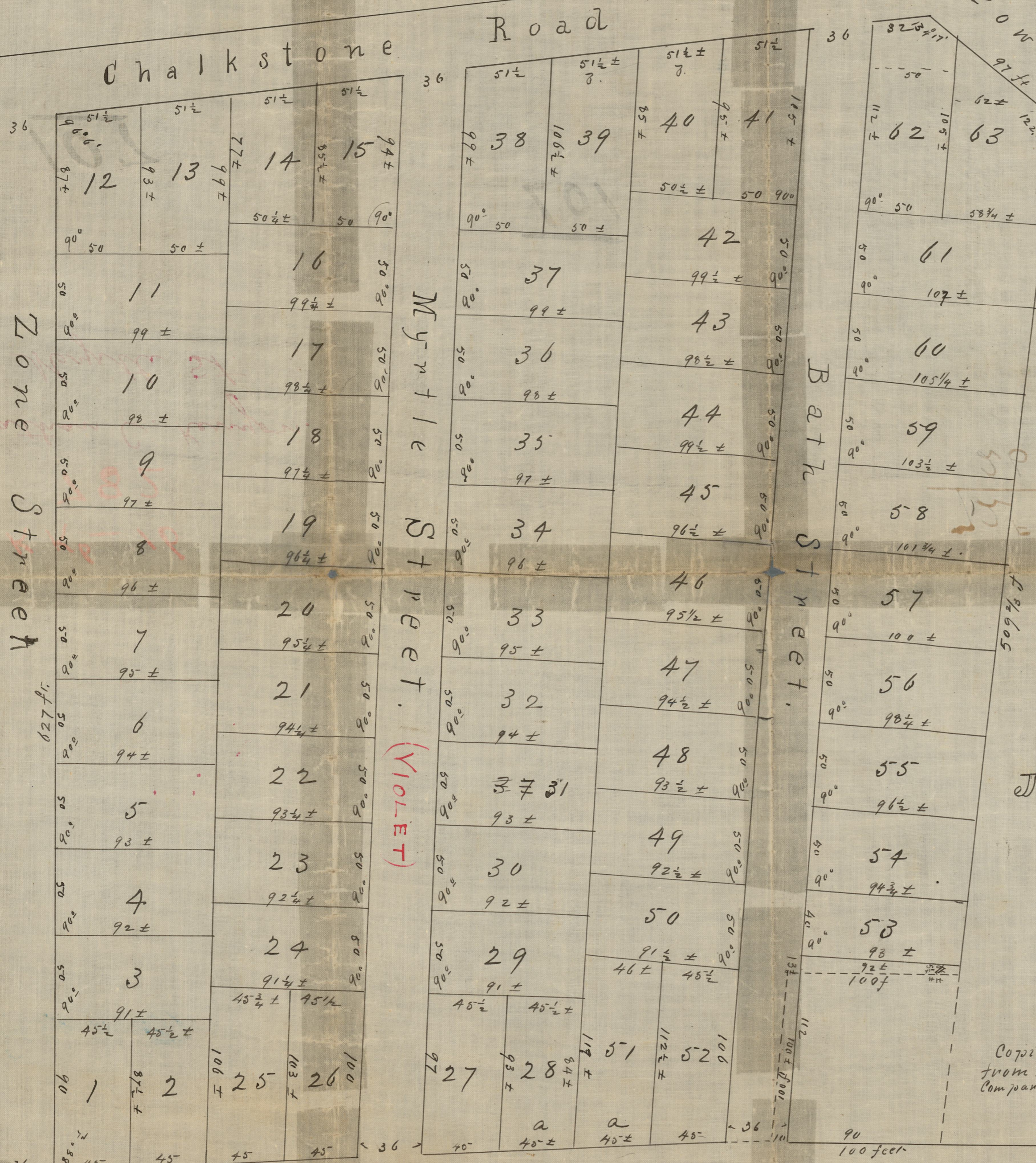

COPIES OF TENTH WARD PLATS
 City Engineer's Office
 No. 37.
 NOT TO BE TAKEN FROM THE OFFICE.

PLAT
 of House Lots in North Providence
 belonging to
JONATHAN C. KENYON.
 Surveyed & Platted Dec 1849
 by
 Cushing & Farnum
 Scale 50 feet to an inch
 U.S. Standard
 This sign ± denotes more or less
 (Card 374)

Copied by H.E.S. July 23 1871. In this survey the existing fences were taken as representing the boundary lines. Compared by H.E.S. & A.V.V. In regard to however some slight irregularities in the fence on the Olneyville Road.

Olneyville Road

The Distances at a are to be equal to each other
 also " " " " " "

South

OFFICE No. 269
 DRAWER " 72
 SHEET " F-16