

82.801  
 -18.66  
 82.8  
 1.406  
 -5.866

# PLAT

of the  
**ANGELL & SAMPSON LAND,**  
 SITUATED IN OLNEYVILLE, NORTH PROVIDENCE.

BY  
 Cushing and Farnum  
 1852.

COPIES OF TENTH WARD PLATS  
 City Engineer's Office  
 No. 83  
 NOT TO BE TAKEN FROM THE OFFICE.

(Card 356)

Note.—This plat includes the same land with the "Plat of House Lots in Olneyville belonging to Abiel Sampson and Jonathan & Joseph Lumsy and Platted May 1851 by Cushing & Farnum" by which plat-lot-lot-lots have been made. The change which will be found in the streets lying between Sampson Street and the River are made according to a written agreement entered into by all the parties interested therein.

CITY ENGINEER'S OFFICE  
 MISCELLANEOUS DEPT.  
 1852  
 0320

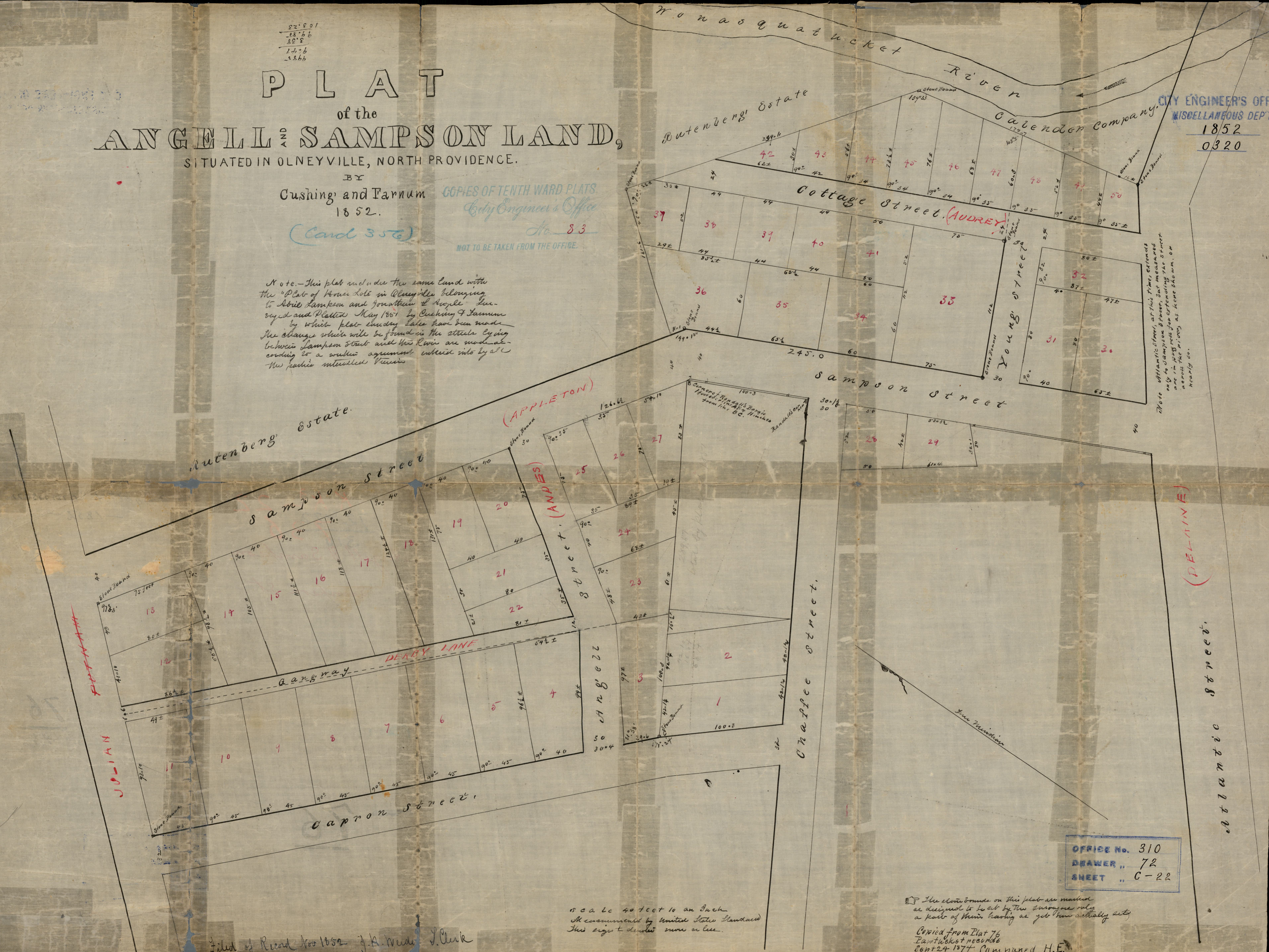

OFFICE NO. 310  
 DRAWER .. 72  
 SHEET .. C-22

Scale 40 feet to an Inch  
 Measurements by United States Standard  
 This sign to double more or less.

The stone bounds on this plat are marked as designed to be set by the surveyors only, a part of their having as yet been actually set.  
 Copied from Plat 76  
 Eastwick records  
 Sept 24 1874 Compared H.E.

Filed of Record Nov 1852 J.A. Wood J. Clark