

Magnetic Meridian for July 10-1863

MAP
 of lots belonging to
 SAMUEL HEDLY,

Drawn by
 J. S. Hamer
 City Engineer's Office. Sept 24th 1863
 No. 10.

(Card 305)

Scale 20ft to an inch
 By U.S. standard

NOT TO BE TAKEN FROM THE OFFICE.

Note - The outbounds of these lots are the same
 as the outbounds of lot No 8 on the Map of lots
 at Mt. Pleasant, N. Providence belonging to Thomas
 G. Hazard surveyed and drawn by Wm. S. Hamer
 July 10th 1863

Copied from plat 5
 Pawtucket records
 Sept 16 1874.
 Compared H.E.S.

This Street runs through
 S to Elizabeth street on Plum Plot
 S Hedly

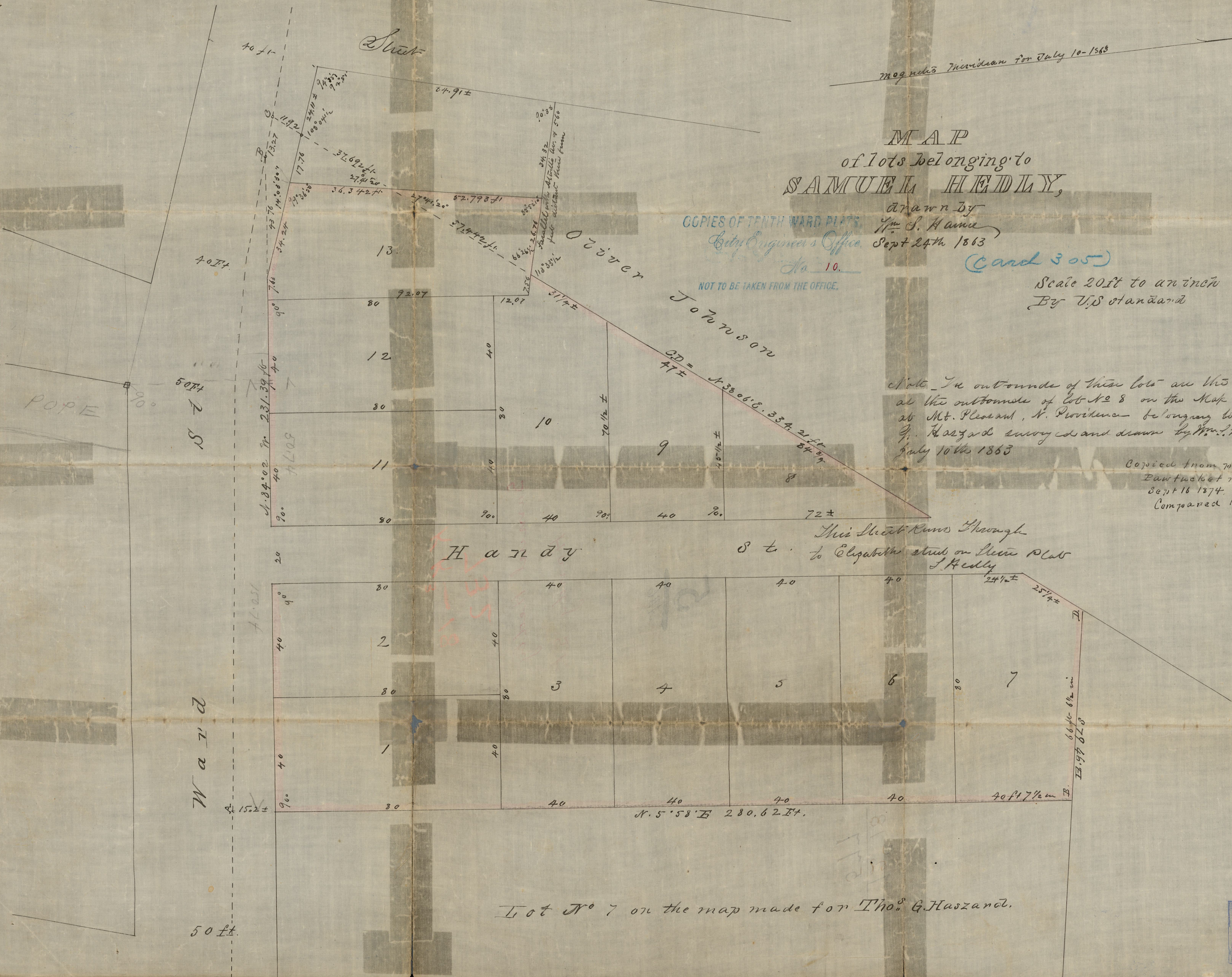

Lot No 7 on the map made for Tho. G. Hazard.