

Widow Brown's land.

CITY ENGINEER'S OFFICE.  
MISCELLANEOUS DEPT.

1857  
0451

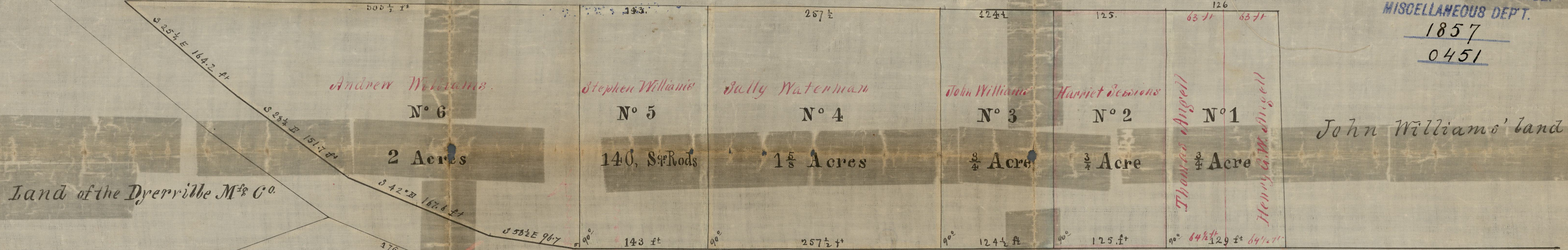

**PLAT**  
OF THE ESTATE OF THE LATE  
**ANNA WILLIAMS.**  
NORTH PROVIDENCE  
as divided among the Heirs  
Lemuel Angell W<sup>m</sup> Earle & Obadiah Brown  
Commissioners.  
Surveyed & Platted by Cushing & Farnum  
1857

COPIES OF TENTH WARD PLATS.  
City Engineer's Office.  
No. 146  
NOT TO BE TAKEN FROM THE OFFICE.

cond 368

Scale 80 Feet to an Inch.

OFFICE No. 440  
DRAWER " 72  
SHEET " C-14

From Plat 94  
Compared H.E.S.