

PLAT. III, SE. PLATS. OLD KILLINGLEY ROAD

Apr. 1873  
01675

ESTABLISHED BY THE TOWN COUNCIL OF THE TOWN OF  
NORTH PROVIDENCE, R.I. APRIL 7, 1873.

SCALE HOR. 40 FT = INCH  
VER. 5 FT = INCH.

D.L. WILKINSON, SUR.

COMMITTEE

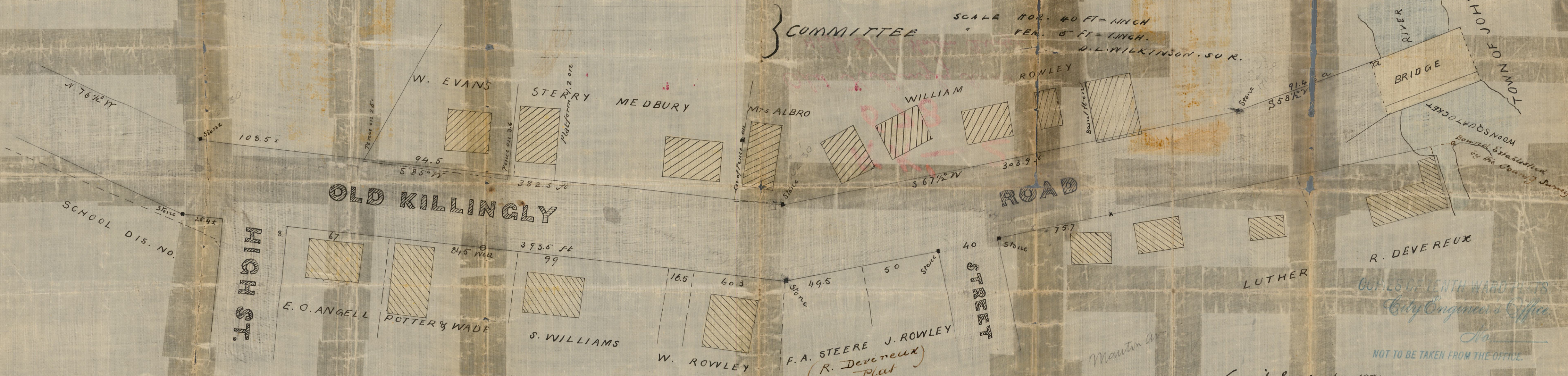

R. DEVEREUX

LUTHER

Copies of Tenth Ward Plats  
City Engineer's Office

NOT TO BE TAKEN FROM THE OFFICE.

Copied June 1. 1874.  
by Sam. G. Kent.

asst. City Engin. Office.  
from original Plat.

OFFICE No. 1384  
DRAWER " 72  
SHEET " A-2

Survey of same by E. O. Angell.  
Price matter of sheet 49 1/2 feet.