

*MD 207*  
 SHOWING LINES AND GRADES OF  
 Common Carroll Wirthrop and Winsor Streets  
 North Providence

as laid out and established by  
 Charles E. Hall Geo. L. Wood and H. A. DeWitt  
 a committee appointed by the Town Council of the  
 Town of North Providence Oct 18, 1866  
 Surveyed and drawn by  
 Cushing B. DeWitt  
 1867.

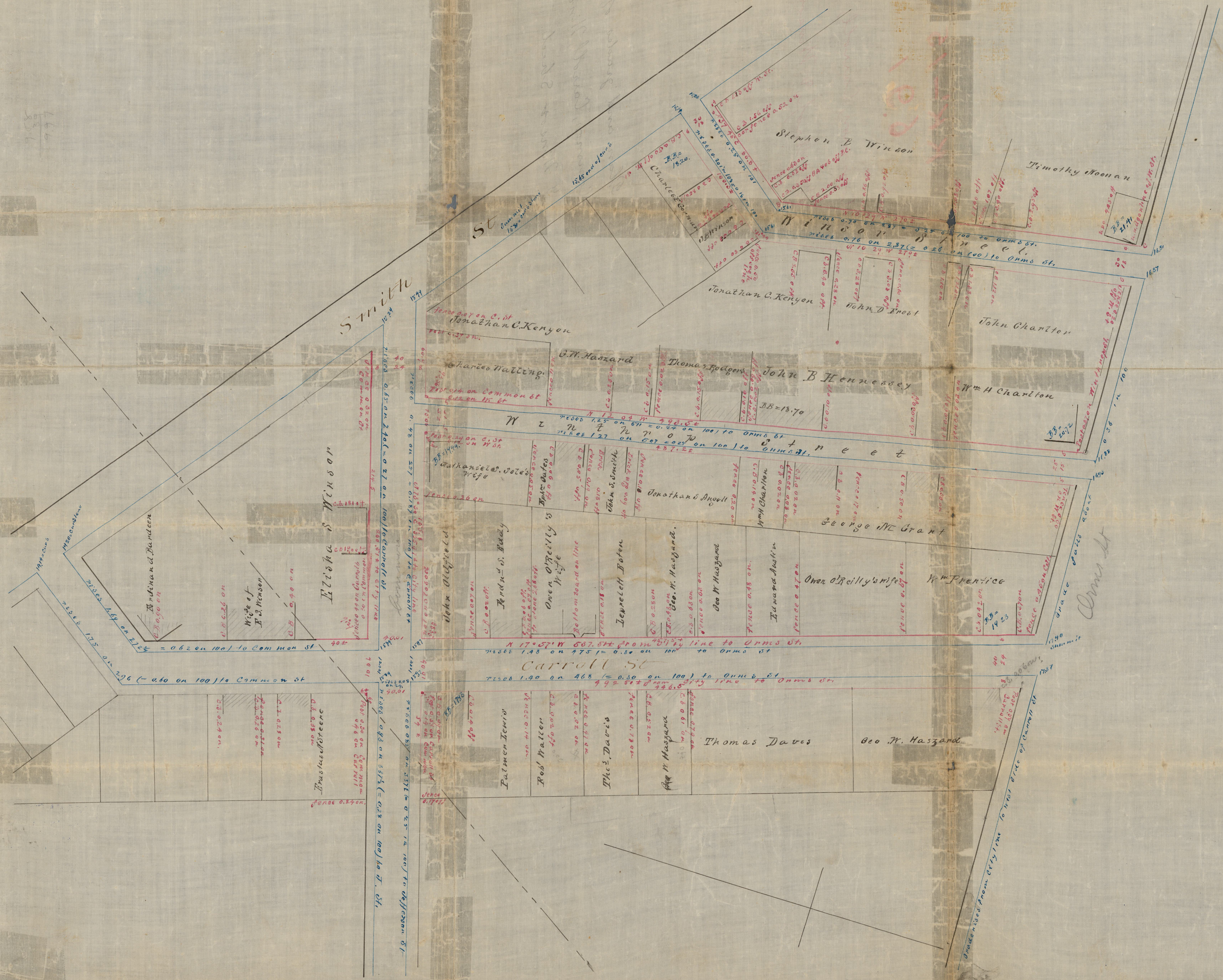

OFFICE No. 804  
 DRAWER " 72  
 SHEET " A-15

Scale of plan, 40 feet to an inch  
 Measurements in feet and decimals, by United States Standard measure  
 All lines and figures in *RED* ink refer to the street lines as laid down by the  
 Committee, and to the distances on and between the same  
 The lines in *Blue* ink represent corner lines and the figures in *Blue*, placed at  
 angles in card lines, denote comparative grades at those points and the *Blue*  
 figures placed on various houses denote comparative elevations of Bottom  
 of Bottom Boards of such houses Grades of each Caroline are described in *Blue* ink  
 "C.B." denotes Corner Boards "B.B." denotes Bottom of Bottom Board ± denotes more or less