

PROVIDENCE, R. I.
CITY ENGINEER'S OFFICE

STREET LINE DEPT.

June 27, 1913

039446

Note, The area declared a public highway is indicated by the letters ABCD.

The lines thus fixed conform to the deeds recorded in Deed Book 486, page 477, Deed Book 494, page 399, and Deed Book 528, pages 110, 124 and 128 in the office of the Recorder of Deeds.

PLAT OF MT. PLEASANT AVENUE

FROM SOUTHERLY LINE OF DOVER ST.
TO CHALKSTONE AVE.
IN TWO SHEETS,

SCALE 60 FEET PER INCH.
DECLARED A PUBLIC HIGHWAY
BY RESOLUTION OF THE
BOARD OF ALDERMEN.

April 17, 1913.

1144.10
1144.62
1144.36

Witness _____
City Clerk

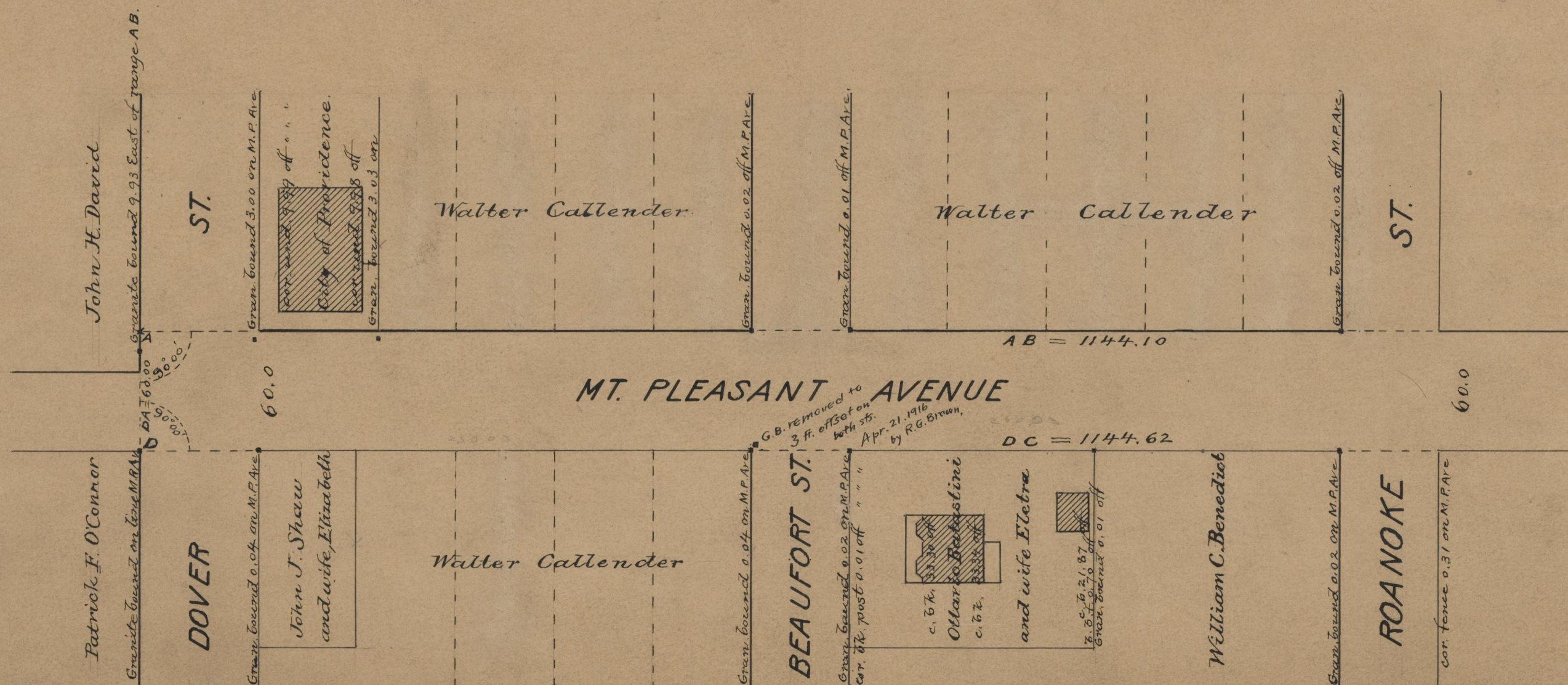
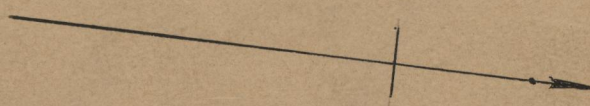

OFFICE No. 19078
DRAWER 71
SHEET B-82