

PROVIDENCE, R.I.
CITY ENGINEER'S OFFICE
STREET LINE DEPT.

Sept. 18, 1912

038943

PLAT OF SMITH STREET

FROM FRANCIS ST. TO CHALKSTONE AVE.

IN FOUR SHEETS

SCALE 60 FEET PER INCH.

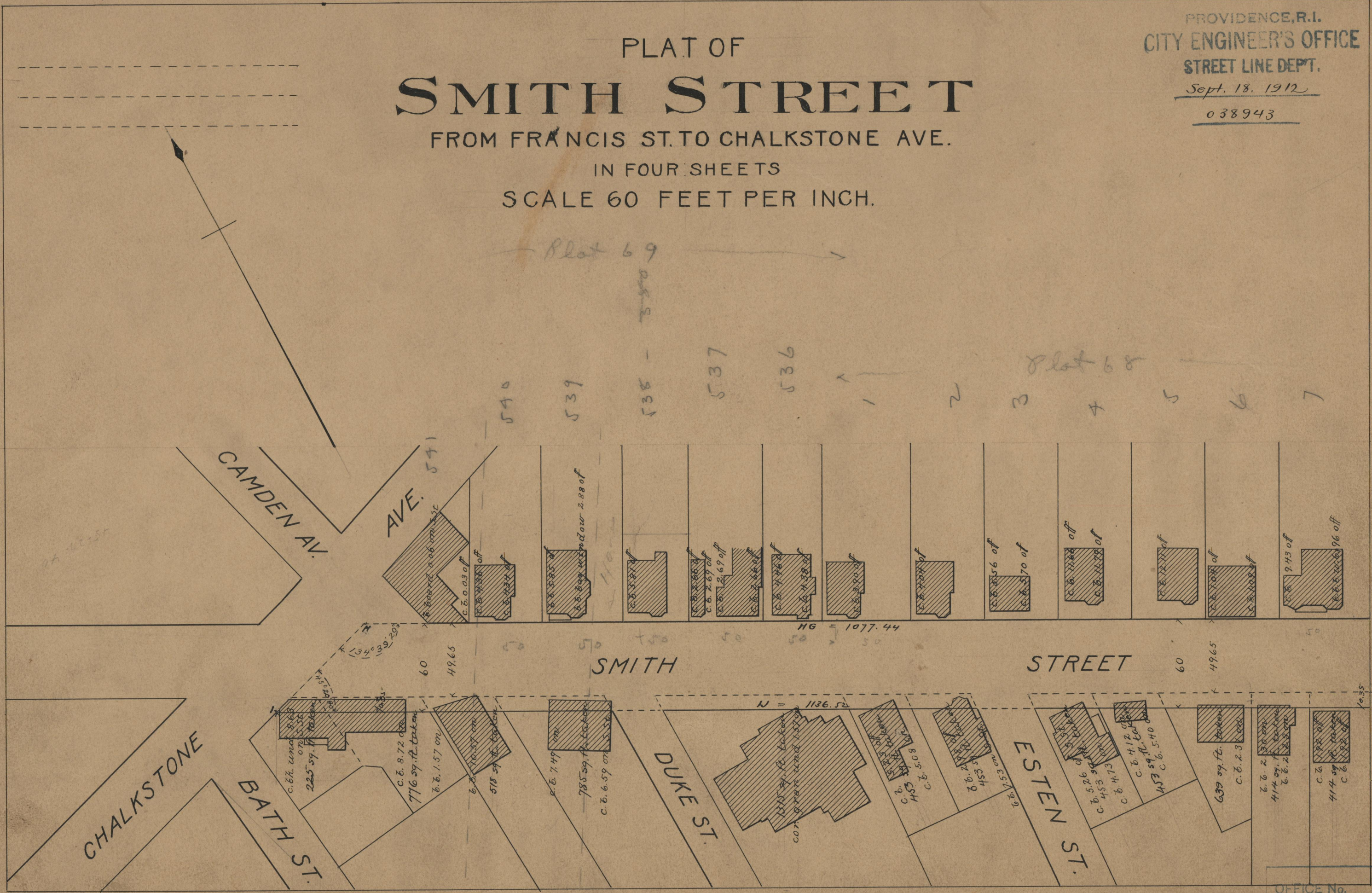

OFFICE No.	18896
DRAWN	71
SHEET	B-62

71
B-62