

PROVIDENCE, R.I.
CITY ENGINEER'S OFFICE

STREET LINE DEPT.

July 28, 1911

037982

PLAT OF ABBOTT PARK PLACE

FROM WEYBOSSET ST. SOUTHERLY.

SCALE 20 FEET PER INCH.

DECLARED A PUBLIC HIGHWAY BY THE
BOARD OF ALDERMEN

September 21, 1911.

(BY REASON OF TWENTY YEARS USE)

Witness,

City Clerk

87.26
19.85
63.81
108.13
119.75
2390.50
195.25

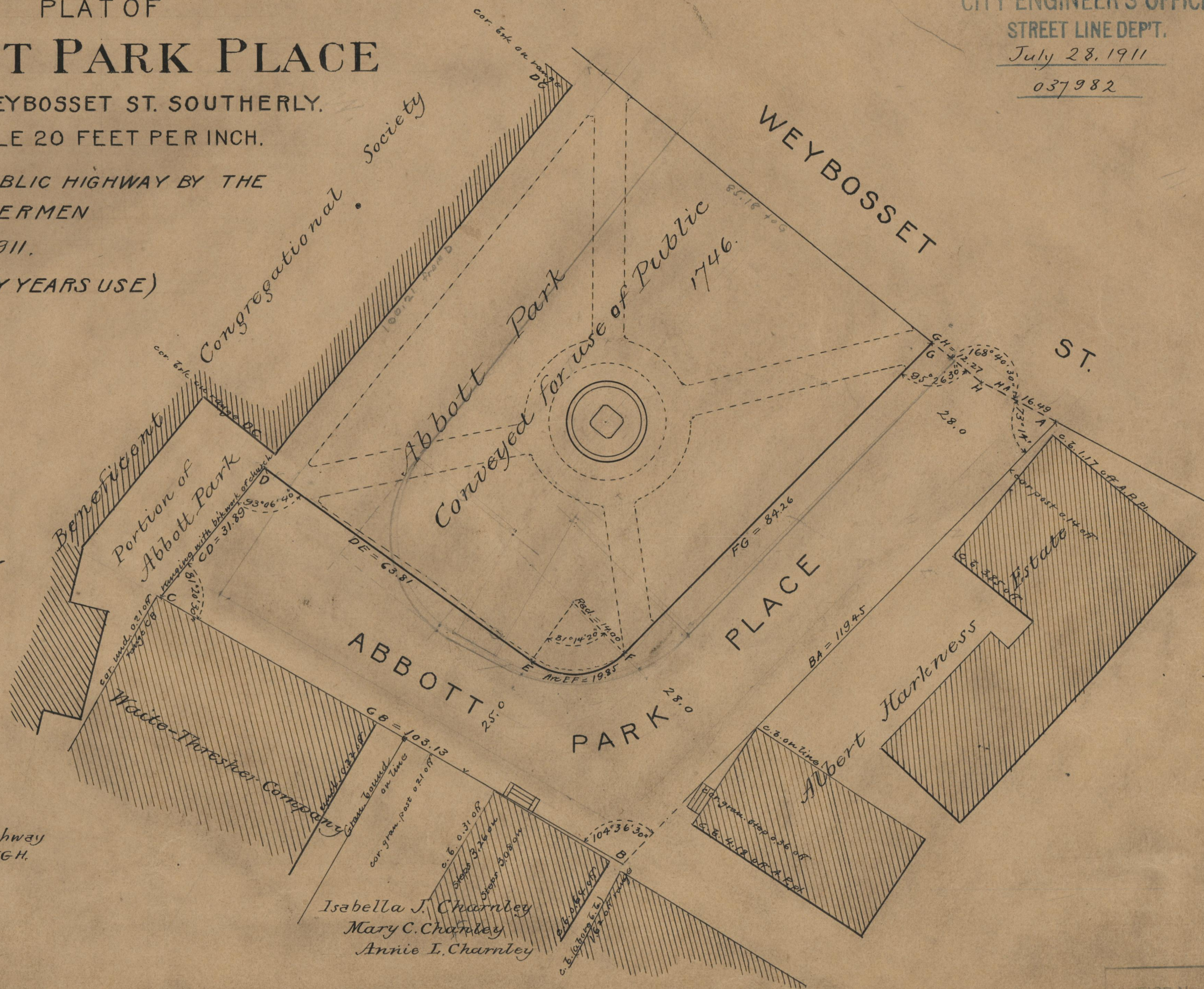

Note, The area declared a public highway
is indicated by the letters ABCDEFGH.

OFFICE No. 18565
DRAWER 71
B-19