

PROVIDENCE, R.I.  
CITY ENGINEER'S OFFICE  
STREET LINE DEPT.

Dec. 29, 1906

034825

Note: The limits of the area declared a public highway are indicated by the letters A B C D  
The lines conform to the deed in Deed Book 434, at page 316, in the office of the Recorder of Deeds

# PLAT OF MONTAGUE STREET

FROM HOPE ST. TO MORRIS AVE.

SCALE 50 FEET PER INCH.

DECLARED A PUBLIC HIGHWAY  
BY RESOLUTION OF THE  
BOARD OF ALDERMEN,  
November 15, 1906.

Witness, \_\_\_\_\_

City Clerk

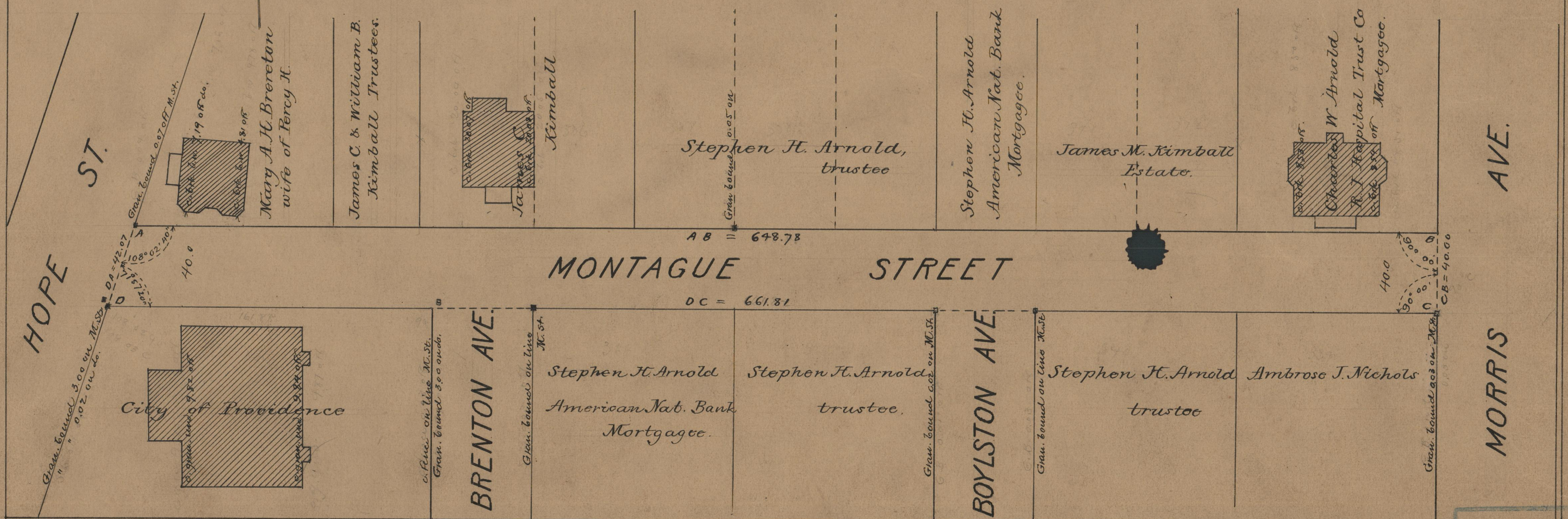

OFFICE NO.	17332
DRAWER	71
SHEET	A - 9