

PLAT AND PROFILES OF LATHAM,  
 LEWIS AND NORTH ALLEN STREETS  
 ON LATHAM PLAT. JOHNSTON, R. I.

ORDERED BY COUNCIL, MARCH 1884  
 GRADES ESTABLISHED, JUNE 1884

See Council Records No 5 pages 440-448

COMMISSIONERS, BENJAMIN F. EVANS,  
 OLIVER P. SHERMAN,  
 ANDREW WINSOR.

SURVEYED, SEPT. 1883.  
 PLATTED, MAY 1884.  
 BY D. D. WATERMAN.

HORIZONTAL SCALE, 40 FEET PER INCH.  
 VERTICAL SCALE, 10 FEET PER INCH.



The grade of Lewis St. was changed by the  
 Town Council Nov. 12, 1891 see Council Rec. No. 68 p. 29  
 and Book of Streets p. 129 and see  
 profile in Manual A No 45  
 M. F. King Council Clerk

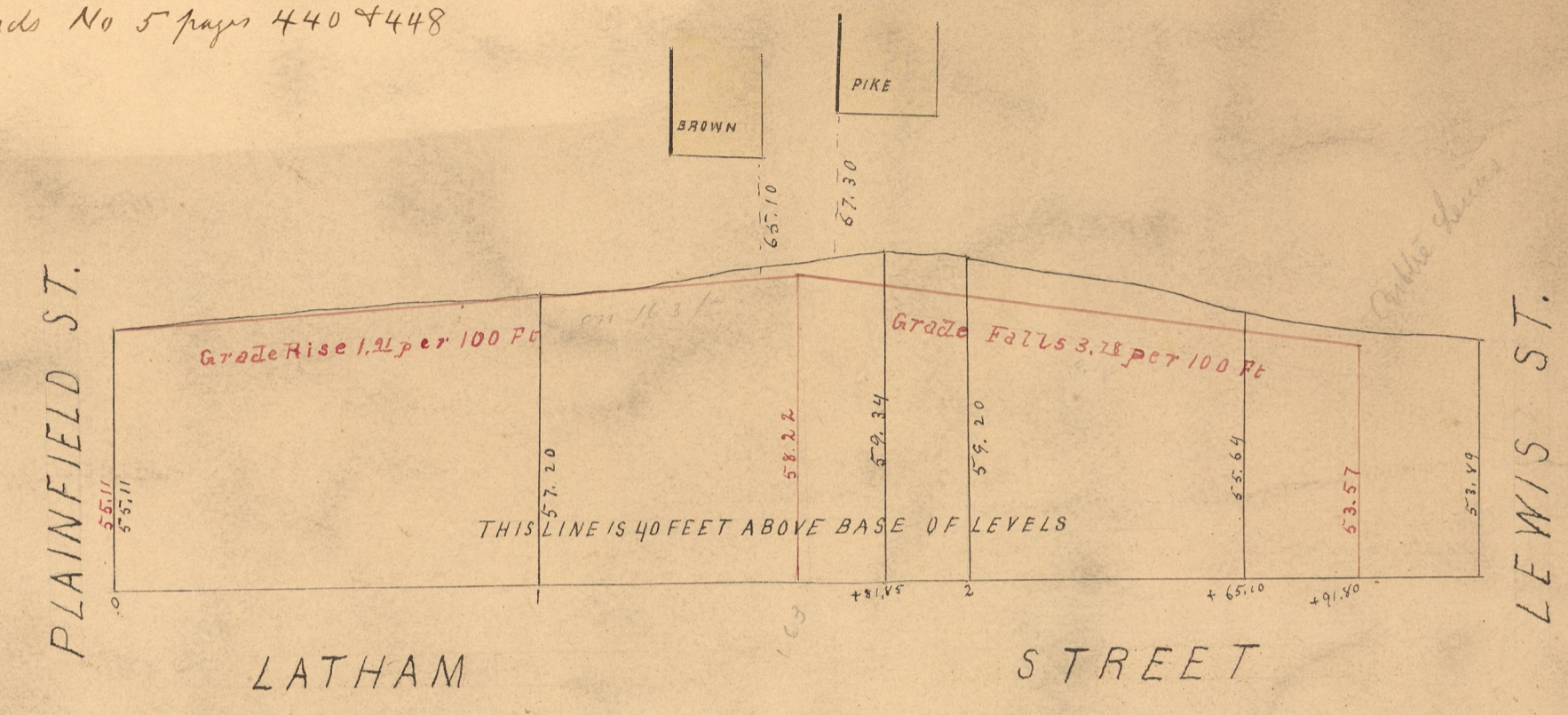

Lewis St. changed to Lona St.  
 N. Allen St. changed to Judith St.  
 July 7, 1898.

Note - The grade of North Allen St  
 was changed by the Town Council  
 November 12, 1891 see Council Rec. No. 68  
 page 429 and Book of Streets page 129  
 and see profile drawer A No 44  
 M. F. King Council Clerk