

PLAT of UNION AVENUE

FROM DYER AVE. to LAUREL HILL AVE.

As laid out by

John W. Waters
Christian G. Kranich
James Davis

Committee appointed by Hon. Town Council
October 1890

R. S. Mowry Surveyor

Scale 50 ft = 1 inch

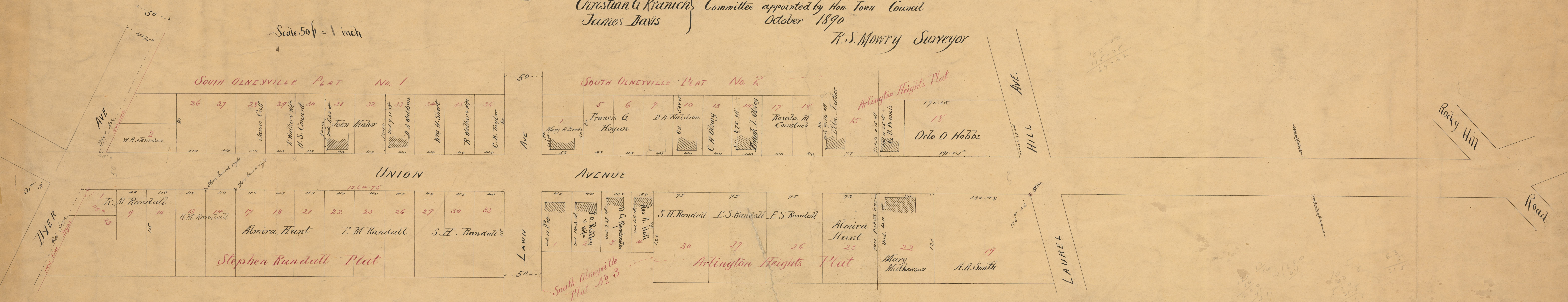

Handwritten calculations and notes in the bottom right corner, including numbers like 1264.75, 130.48, and 191.43.