

PLAN

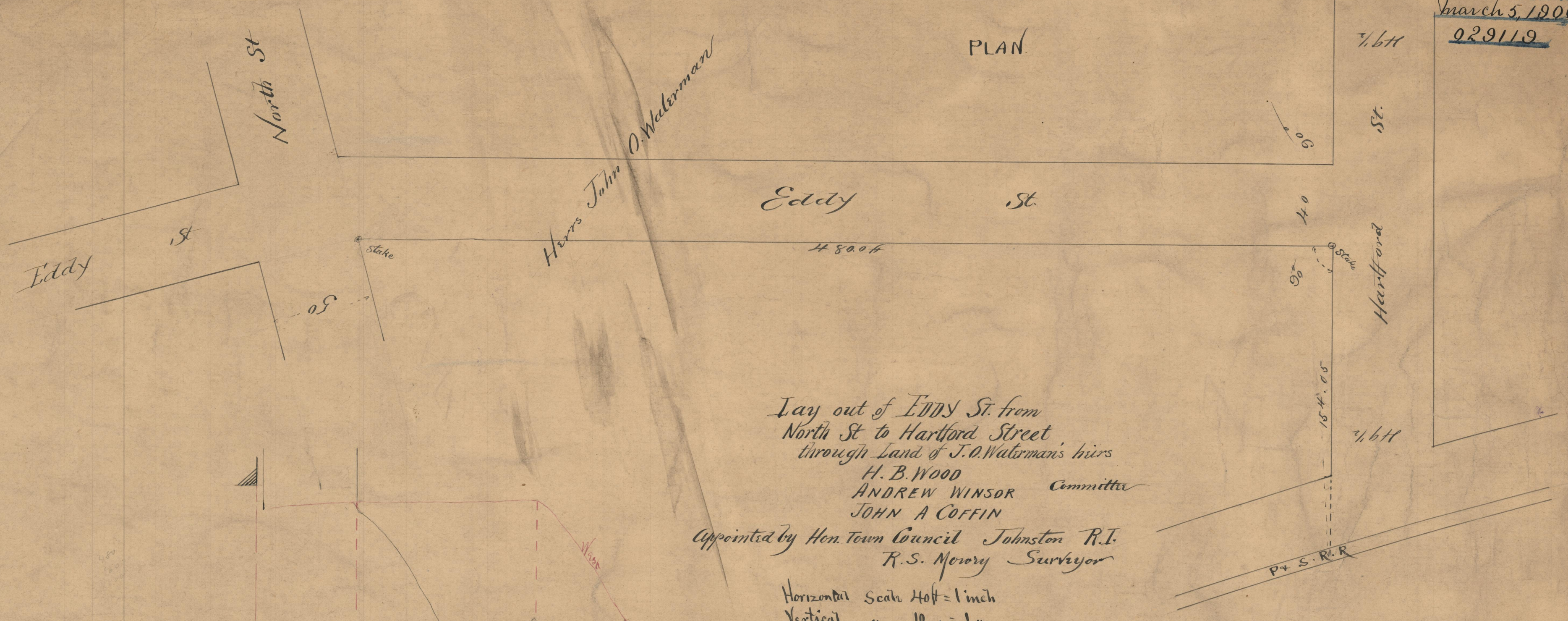

Lay out of *EDDY St.* from
 North St to Hartford Street
 through Land of J. O. Waterman's heirs
 H. B. WOOD
 ANDREW WINSOR *Committee*
 JOHN A. COFFIN
 Appointed by Hon. Town Council Johnston R.I.
 R. S. MERRY *Surveyor*
 Horizontal Scale 40ft = 1 inch
 Vertical " 10 " = 1 "

*Eddy St. changed to Hoath St.
 July 7, 1898.*

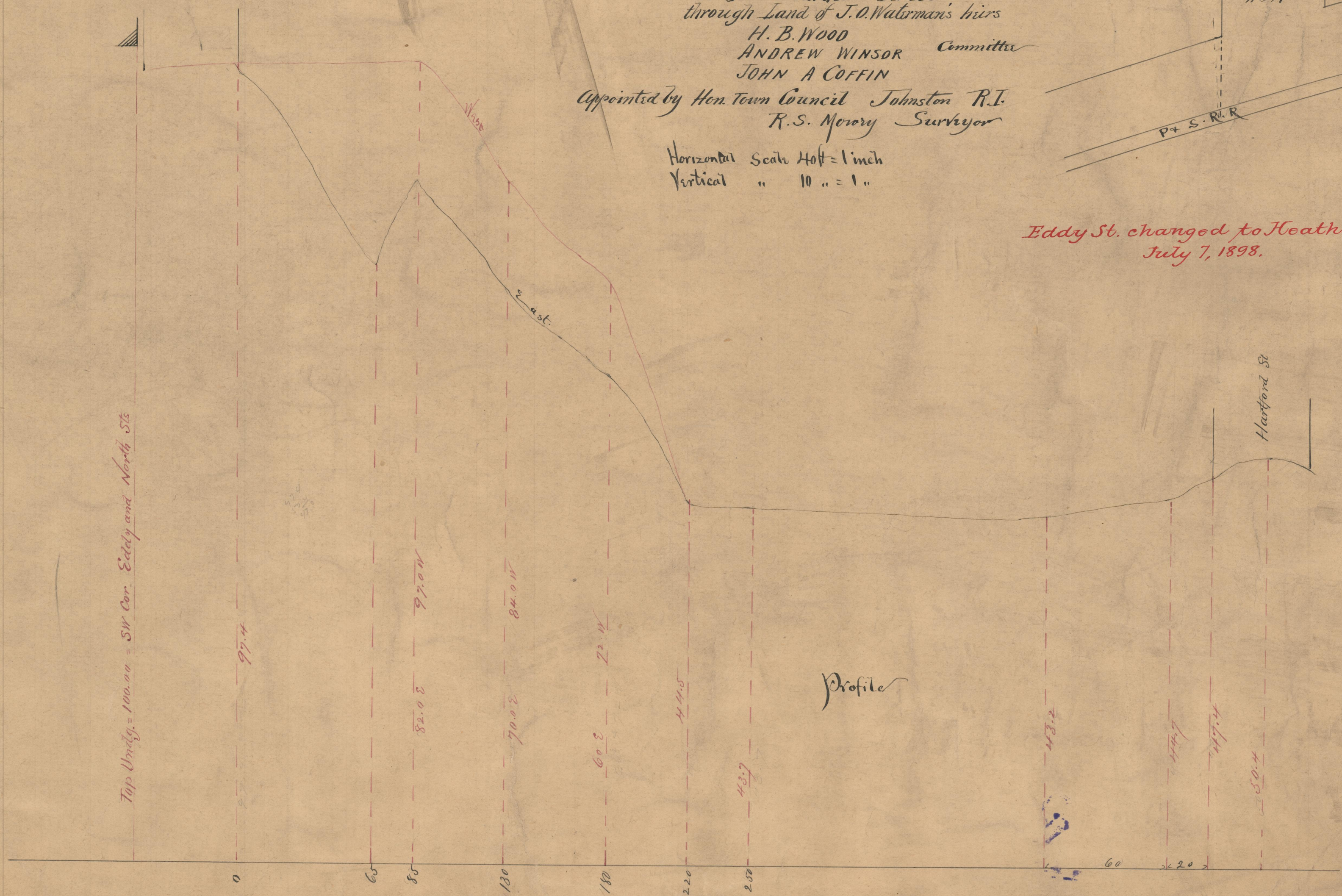

Profile