

Profile of MILLER AVE from Andrews Ave to Dyer Ave.

Showing proposed Grade R.S. Mowry Aug. 1890

Horizontal Scale 40ft = 1 inch
Vertical " 10 " = 1 "

See Council Record No 6 page 321
Est. Oct. 23, 1890 *Mrs. King's block*

Miller Ave changed to Union Ave.
Sept. 10, 1897

Grade assumed to be on the
city street line + change of grade
at corner of Andrews Av. 2nd

PLAN

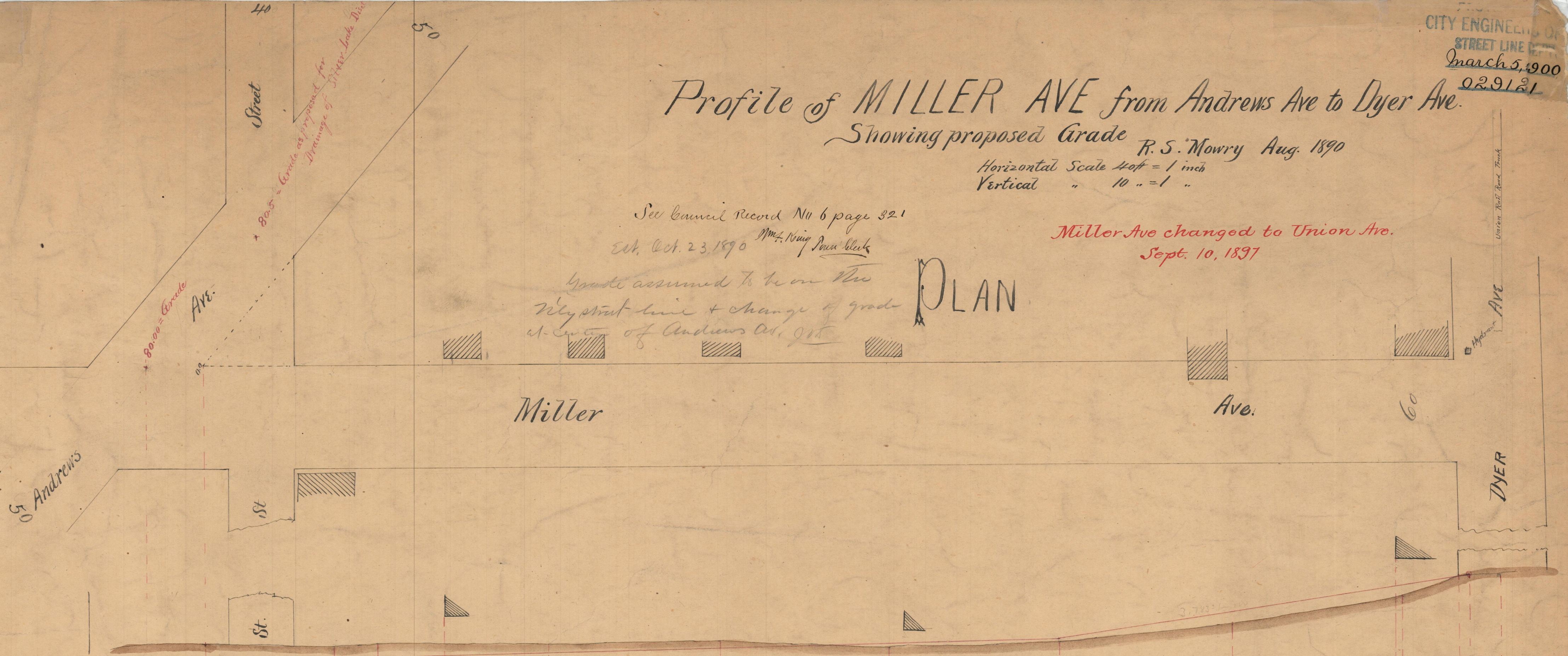

PROFILE

