

227  
227  
454

# WINSOR STREET

JOHNSTON R.I.  
FROM PLAINFIELD ST. TO McDONOUGH ST.

SURVEYED AND PLATTED DEC. 1885  
BY D.D. WATERMAN

SCALE 30 FT. PER INCH

COMMITTEE

*George M. White*  
*Geo. Gifford*  
*Wm. F. King*

*Winsor St. changed to Atwood St.  
July 7 1898.*

PROVIDENCE  
CITY ENGINEER'S OFFICE  
STREET LINE DEPT.  
Feb. 28, 1900  
029036

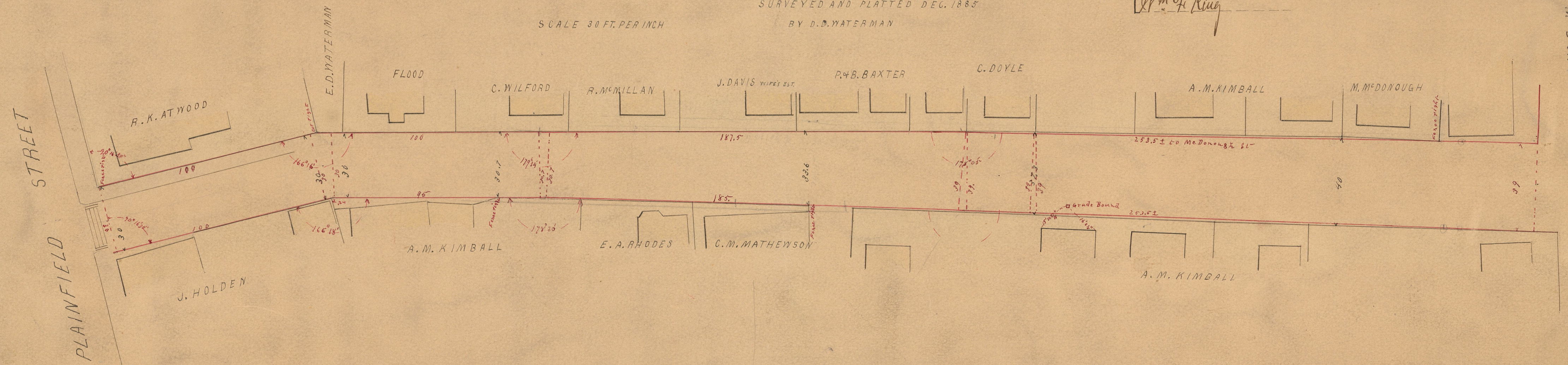

OFFICE No. 17175  
DRAWER 70  
SHEET 105

*Taxation*

*Official Map*