

PROVIDENCE CITY ENGINEER'S OFFICE
STREET LINE DEPT.
Feb. 22, 1900
02:0071

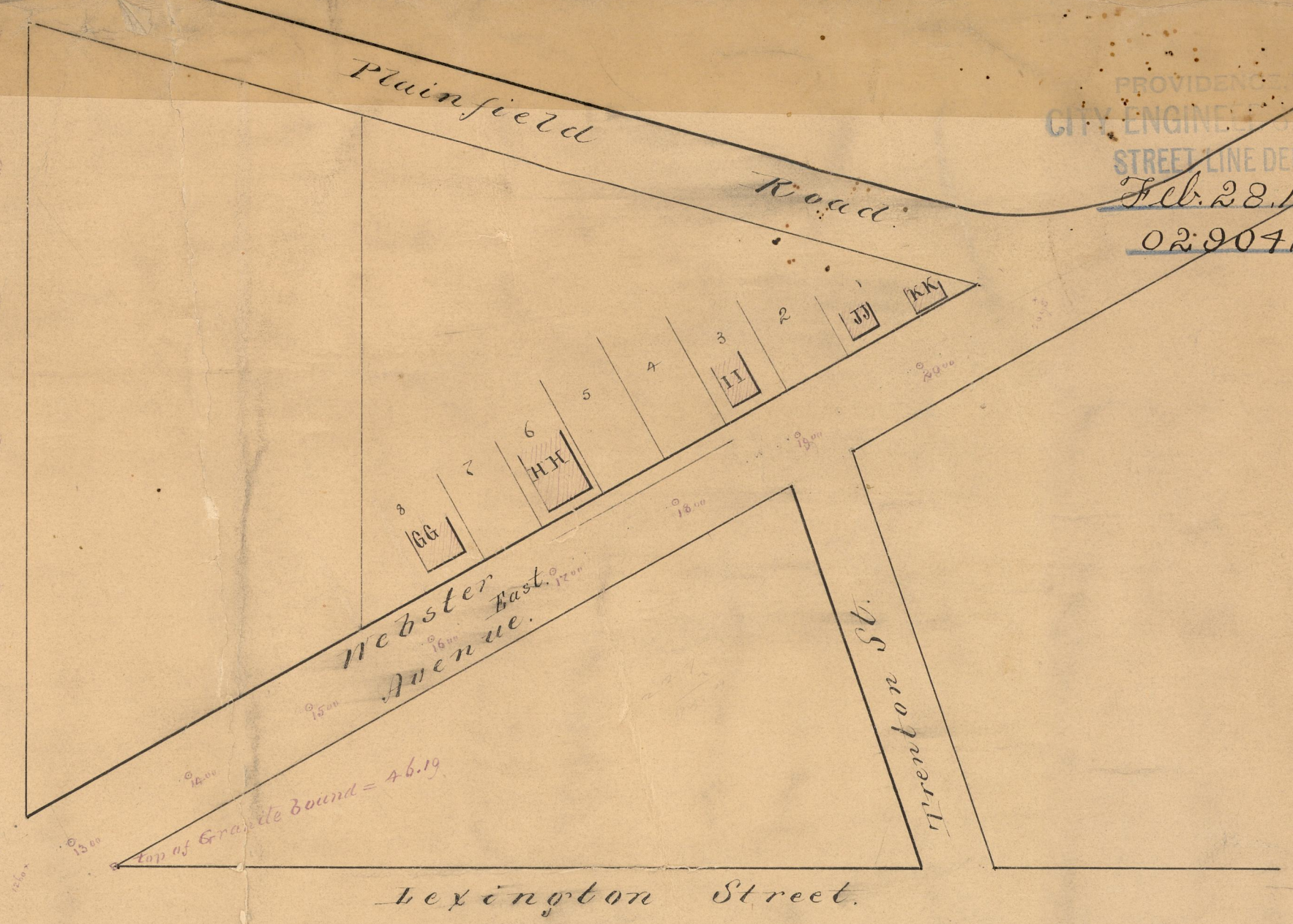
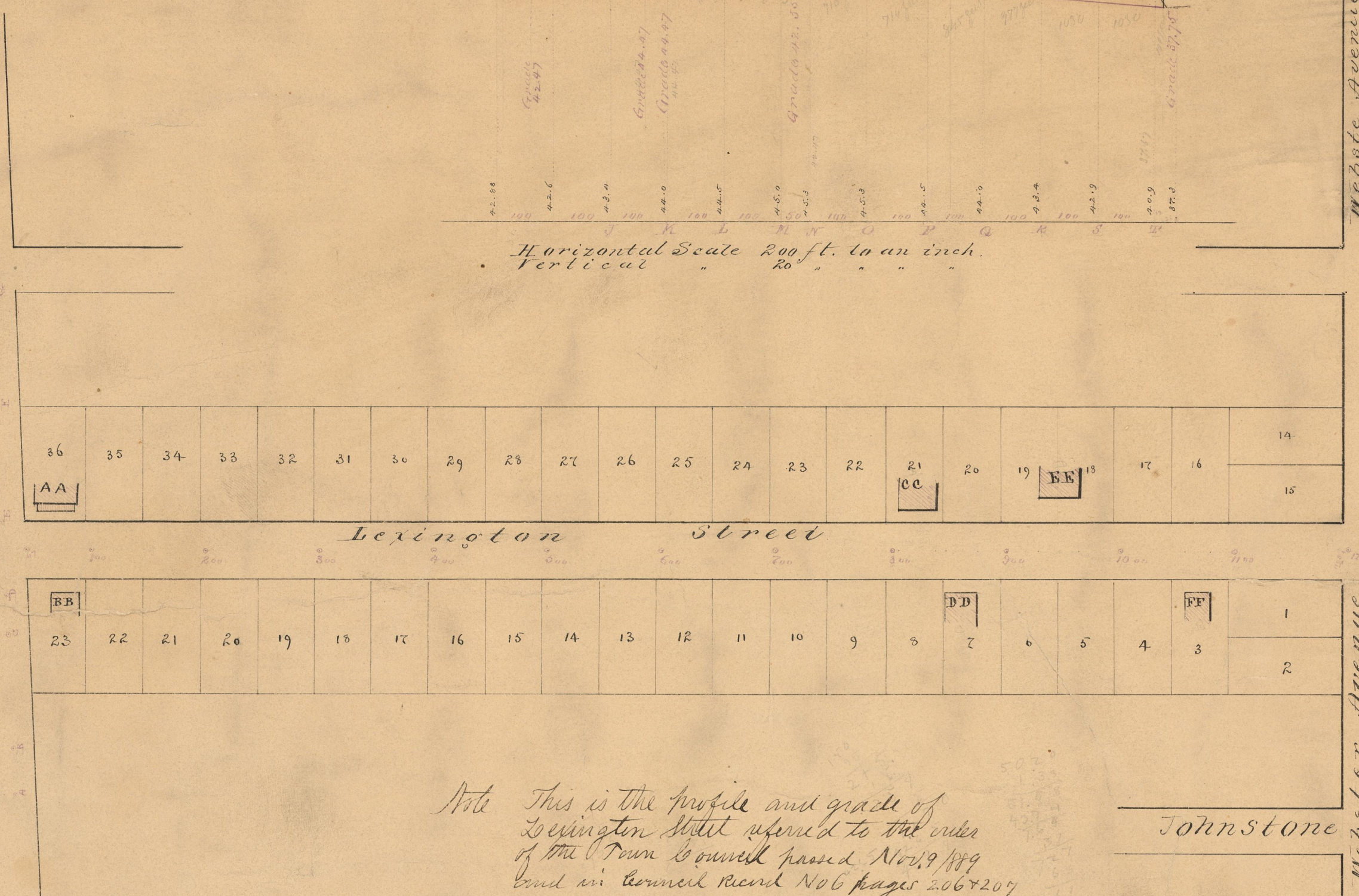
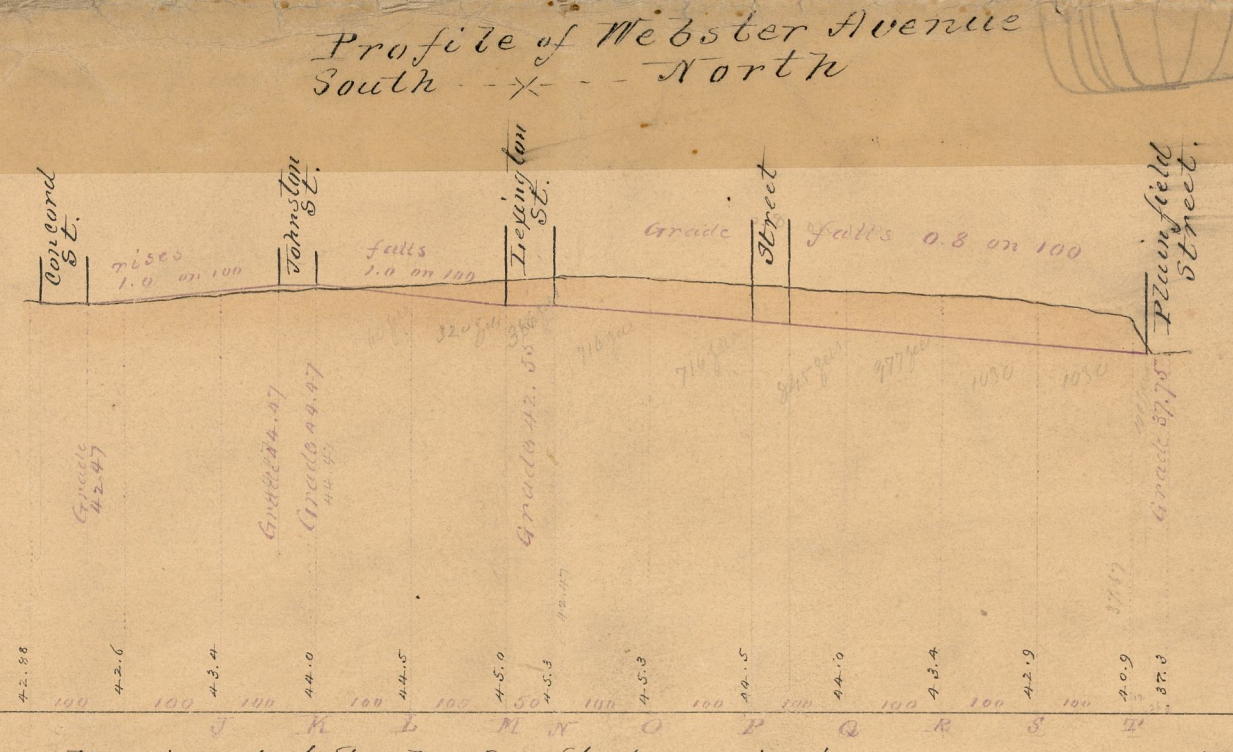
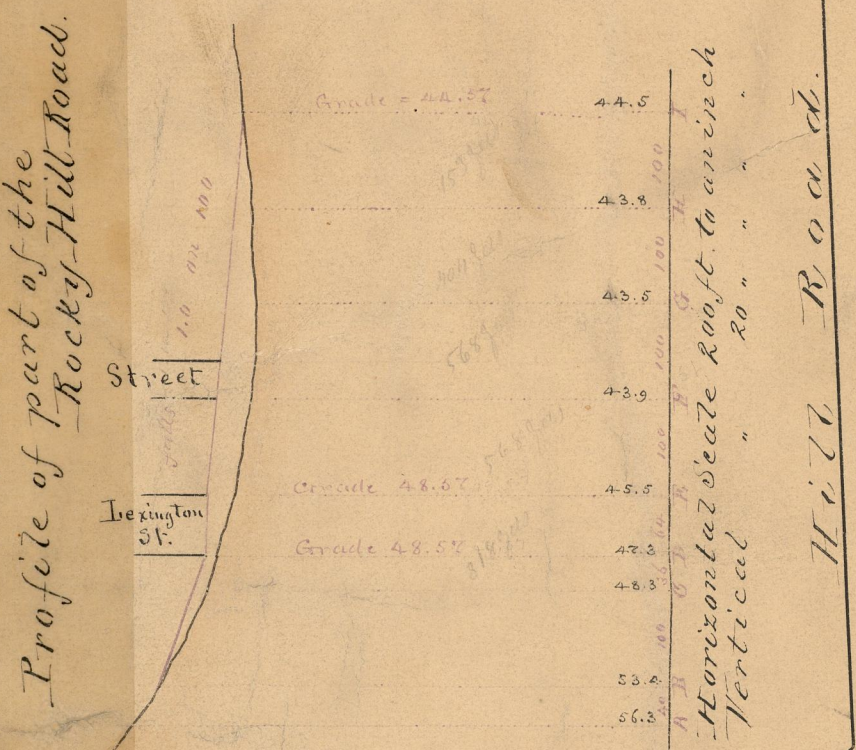

Note This is the profile and grade of Lexington Hill referred to the order of the Town Council passed Nov. 19, 1899 and in Council Record Vol. 6 pages 206 & 207
Jm. F. King Jun. Clerk

Rocky Hill Rd. changed to Laurel Hill Ave. May 31, 1893
"Webster Ave. East" named Pocasset Ave.
Lexington St. from R.H. Rd to Webster Ave changed to Pocasset Ave
Lexington St. from Webster Ave. Easterly changed to Magnolia St. July 7, 1898.

Grade falls 0.5 on 100 from 100 ft. West of Rocky Hill Road to station "1932" - 7 1/2 ft. on 1532 ft. total

Profile of Lexington Street

Profile of Webster Avenue East.

Horizontal Scale, 100 ft. to an inch.
Vertical 10 "

Numbers and letters in Profiles refer to corresponding points on Plan.

OFFICE No. 14170
DRAWER 40
SHEET 100

Cushing & De Witt, Nov. 1899.

40
100